

Power Solution Industries



SOLAR PV MOUNTING SYSTEM



SOLAR PHOTOVOLTAIC MOUNTING SYSTEMS

Keeping The Planet Green

Power Solution Industries is one of the leading Cable Management Systems & Cable Support Systems, manufacturing company across the Middle East. Today Power Solution Industries is a 350 plus member team that engineers, produces, manages and delivers the widest range of cable management systems from UAE and KSA, meeting the stringent European and American standards with cutting edge technology and supplying to Middle East market segments in the region.

PSI has extensive purpose built production and logistics facilities, integrating the most advanced fabrication facilities that manufacture & produce around 28,000 tons of Cable Management & supports annually. PSI has established its production and logistics in Riyadh in Saudi Arabia, Ajman in the UAE & Doha in State of Qatar.

The smart initiative of Dubai government is a transition towards a green economy, implementing green initiatives, adopting economic diversification and its commitment to achieving sustainable development, based on knowledge, innovation, and sustainable green growth, to achieve economic prosperity.

The global efforts to reduce the carbon footprints and boost clean environment has energized & encouraged PSI to contribute in the development towards clean energy.

PSI has developed & launched TUV Nord Europe certified full range of Solar Photovoltaic Mounting Systems, which have been designed to suit the local environment & would support all the installations ranging from Ground Mounted to any type of Roof Top Mounted installations. The PSI Mounting Systems are produced to Euro Codes 1, 3, 8, 9 & are in compliance to Dubai Municipality Seismic Design Loads.

The PSI Solar Engineering team can design & customize the mounting systems depending on the site location and provides complete technical support & guidance through all phases of installations.

Power Solution Industries operates within ISO 9001: 2008 requirements & has fully automated production & manufacturing processes which endorses PSI's commitment to total work ethic, quality production, and overall quality in systems and quality services.

PSI is committed to innovation, and consistently performs on par with the industry's highest standards. Power Solution Industries has achieved a trailblazing journey of success across the region, establishing an international reputation, an outcome of a collective vision, reaching out to newer regions and delivering its promise for quality, commitment and building long-term partnerships.

TUV Certified Mounting Systems



QUALITY ASSURANCE

*Power Solution Industries quality plan conforms comprehensively to ISO 9001:2008.
The quality assessment and reviews are carried out by DET NORSKE VERITAS.*

The organization defines its quality objectives at the various levels of the company in order to achieve continual improvement in quality management system.

CONTENTS

GROUND MOUNTED SYSTEMS

PSI EMERALD	Single Pile Double Portrait Mounting Systems. Steel Purlins	1
PSI DIAMOND	Single Pile Double Portrait Mounting Systems. Aluminum Purlins	2
PSI TOPAZ	Single Pile Triple Landscape Mounting Systems. Steel Purlins	3
PSI QUARTZ	Single Pile Triple Landscape Mounting Systems. Aluminum Purlins	4
PSI SAPPHIRE	Double Pile Double Portrait Mounting Systems. Steel Purlins	5
PSI PHOENIX	Double Pile Double Portrait Mounting Systems. Aluminum Purlins	6
PSI RUBY	Double Pile Triple Landscape Mounting Systems. Steel Purlins	7
PSI PLATINUM	Double Pile Triple Landscape Mounting Systems. Aluminum Purlins	8

FLAT ROOF MOUNTED SYSTEMS - Elevated Ballast

PSI OMEGA	Flat Roof Single Portrait Mounting Systems	11
PSI CORONA	Flat Roof Double Portrait Mounting Systems	12
PSI OPAL	Flat Roof Single Landscape Mounting Systems	13
PSI PEARL	Flat Roof Triple Landscape Mounting Systems	14

FLAT ROOF MOUNTED SYSTEMS - With Ballast

PSI CORAL	Flat Roof Single Portrait Mounting Systems	15
PSI ATLAS	Flat Roof Single Landscape Mounting Systems	16

FLAT ROOF LOW HEIGHT MOUNTED SYSTEMS - With Ballast

PSI MERCURY	Flat Roof Single Landscape Mounting Systems	19
PSI HYDRA	East West Flat Roof Double Landscape Mounting Systems	20

INDUSTRIAL / CORRUGATED ROOF MOUNTED SYSTEM

Landscape / Portrait Orientation

PSI ASTRO	Industrial Roof Mounting Systems	Eco System	23
PSI GALAXY	Industrial Roof Mounting Systems	Rail System	25
PSI SIGMA	Industrial Roof Mounting Systems	Cross Rail System	27
PSI ALPHA	Industrial Roof Mounting Systems	Single V Rail System	29
PSI HYDER	Industrial Roof Mounting Systems	Standing Seam System	31
PSI KOLHAI	Industrial Roof Mounting Systems	Low Height System	33
PSI ZABARVAN	Industrial Roof Mounting Systems	Low Height System	34

ISO 9001 : 2008 Certified



PSI EMERALD

Single Pile Double Portrait Mounting Systems with Steel Purlins.



System Arrangement

- This mounting system can be produced and installed in the tables of total length of 12m, 24m & 48m.
- For large scale projects customization of tables could be done.
- The Steel grade used is as per EN 10025 & Hot dip galvanizing to BS EN ISO 1461 : 1999
- The fasteners are used as per CLASS A2 - 70.
- The Inclination / Tilt angle depends on the latitude.
- The distance between the horizontal purlins will be according to the panel dimensions.
- TUV Certified Mounting Systems.

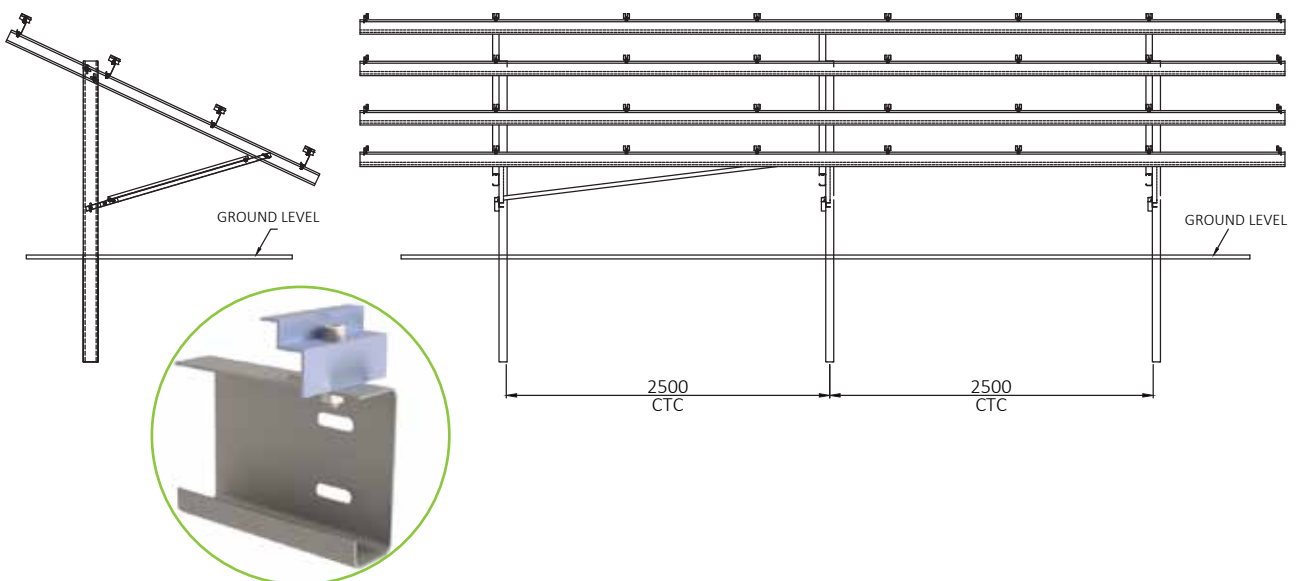

PSI DIAMOND

Single Pile Double Portrait Mounting Systems with Aluminum Purlins



System Arrangement

- This mounting system can be produced and installed in the tables of total length of 12m, 24m & 48m.
- For large scale projects customization of tables could be done.
- The Steel grade used is as per EN 10025 & Hot dip galvanizing to BS EN ISO 1461 : 1999 & Aluminum AA 6063 T6
- The fasteners are used as per CLASS A2 - 70.
- The Inclination / Tilt angle depends on the latitude.
- The distance between the horizontal purlins will be according to the panel dimensions.
- TUV Certified Mounting Systems.

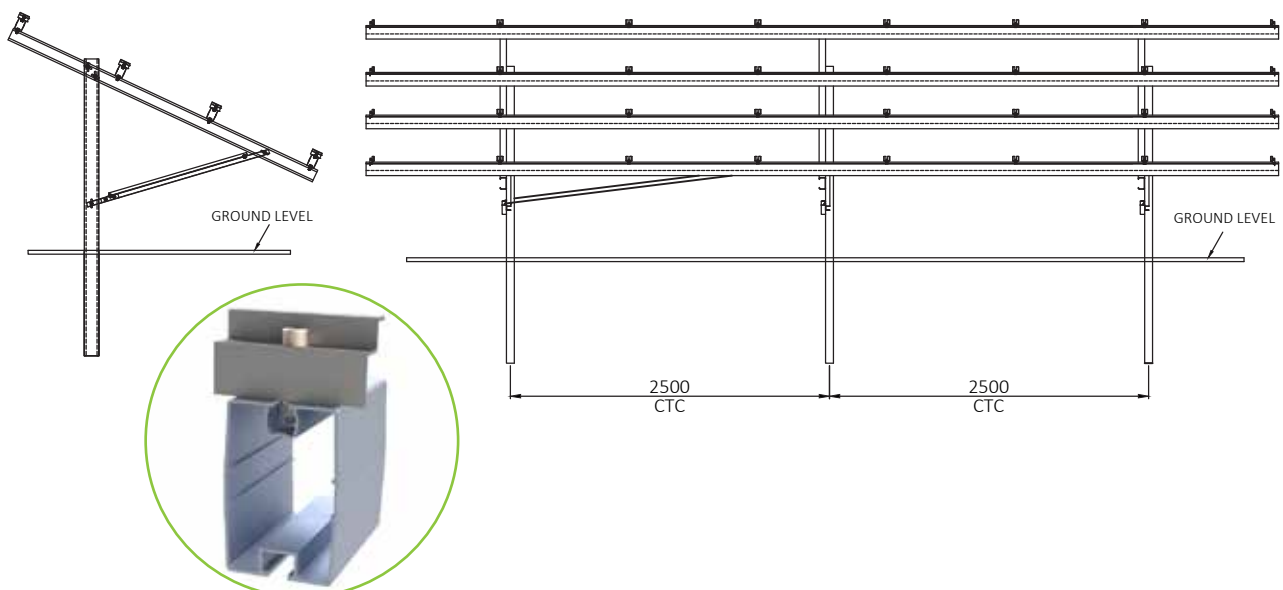

PSI TOPAZ

Single Pile Triple Landscape Mounting Systems with Steel Purlins



System Arrangement

- This mounting system can be produced and installed in the tables of total length of 12m, 24m & 48m.
- For large scale projects customization of tables could be done.
- The Steel grade used is as per EN 10025 & Hot dip galvanizing to BS EN ISO 1461 : 1999
- The fasteners are used as per CLASS A2 - 70.
- The Inclination / Tilt angle depends on the latitude.
- The distance between the horizontal purlins will be according to the panel dimensions.
- TUV Certified Mounting Systems.

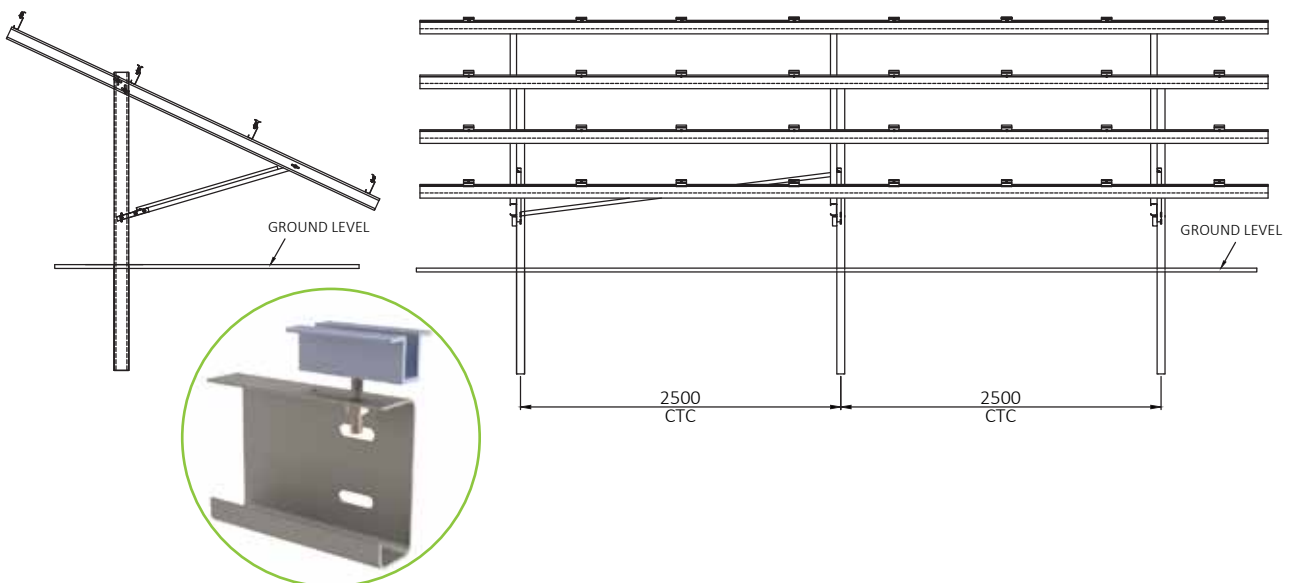

PSI QUARTZ

Single Pile Triple Landscape Mounting Systems with Aluminum Purlins



System Arrangement

- This mounting system can be produced and installed in the tables of total length of 12m, 24m & 48m.
- For large scale projects customization of tables could be done.
- The Steel grade used is as per EN 10025 & Hot dip galvanizing to BS EN ISO 1461 : 1999 & Aluminum AA 6063 T6
- The fasteners are used as per CLASS A2 - 70.
- The Inclination / Tilt angle depends on the latitude.
- The distance between the horizontal purlins will be according to the panel dimensions.
- TUV Certified Mounting Systems.

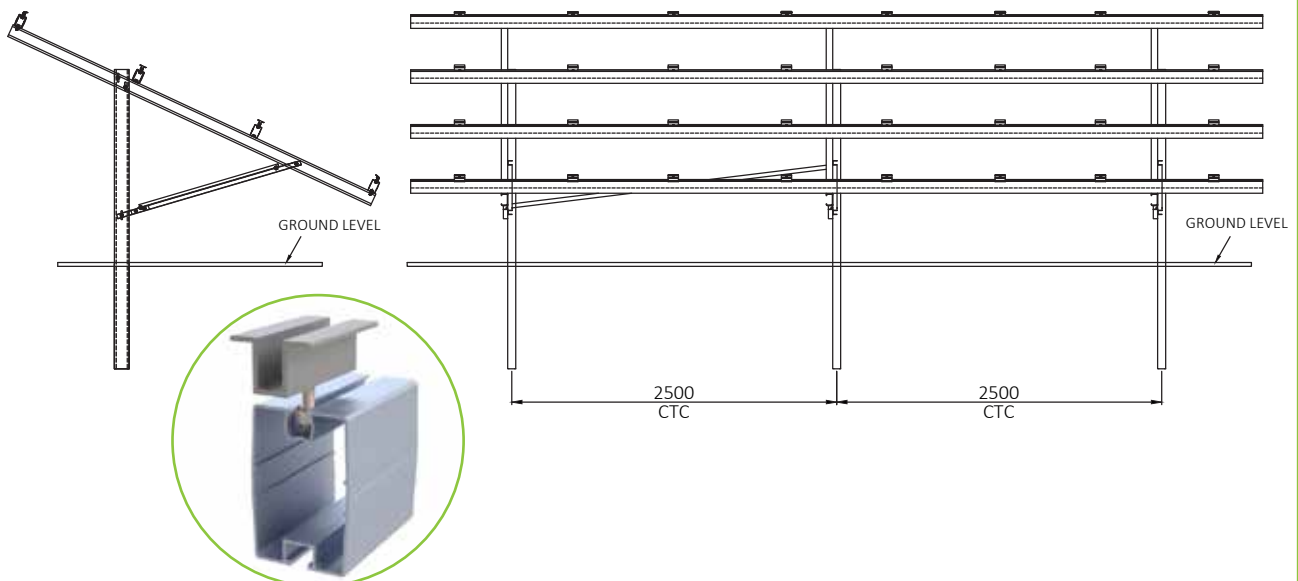

PSI SAPPHIRE

Double Pile Double Portrait Mounting Systems with Steel Purlins



System Arrangement

- This mounting system can be produced and installed in the tables of total length of 12m, 24m & 48m.
- For large scale projects customization of tables could be done.
- The Steel grade used is as per EN 10025 & Hot dip galvanizing to BS EN ISO 1461 : 1999
- The fasteners are used as per CLASS A2 - 70.
- The Inclination / Tilt angle depends on the latitude.
- The distance between the horizontal purlins will be according to the panel dimensions.
- TUV Certified Mounting Systems.

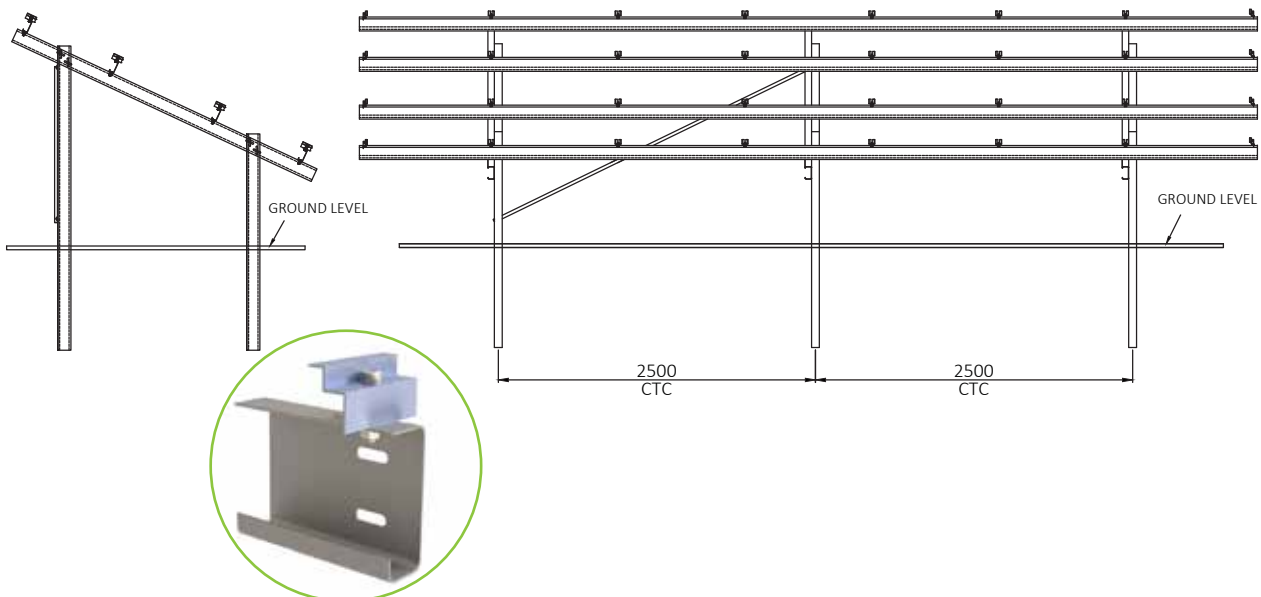

PSI PHOENIX

Double Pile Double Portrait Mounting Systems with Aluminum Purlins



System Arrangement

- This mounting system can be produced and installed in the tables of total length of 12m, 24m & 48m.
- For large scale projects customization of tables could be done.
- The Steel grade used is as per EN 10025 & Hot dip galvanizing to BS EN ISO 1461 : 1999 & Aluminum AA 6063 T6
- The fasteners are used as per CLASS A2 - 70.
- The Inclination / Tilt angle depends on the latitude.
- The distance between the horizontal purlins will be according to the panel dimensions.
- TUV Certified Mounting Systems.

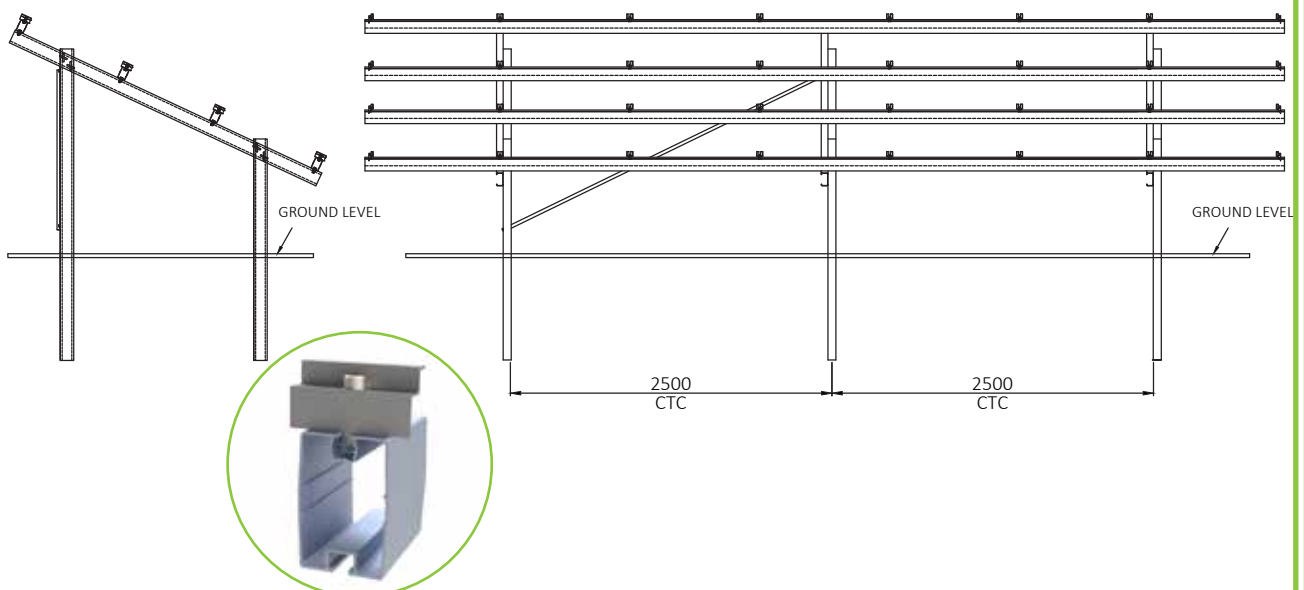

PSI RUBY

Double Pile Triple Landscape Mounting Systems with Steel Purlins



System Arrangement

- This mounting system can be produced and installed in the tables of total length of 12m, 24m & 48m.
- For large scale projects customization of tables could be done.
- The Steel grade used is as per EN 10025 & Hot dip galvanizing to BS EN ISO 1461 : 1999
- The fasteners are used as per CLASS A2 - 70.
- The Inclination / Tilt angle depends on the latitude.
- The distance between the horizontal purlins will be according to the panel dimensions.
- TUV Certified Mounting Systems.

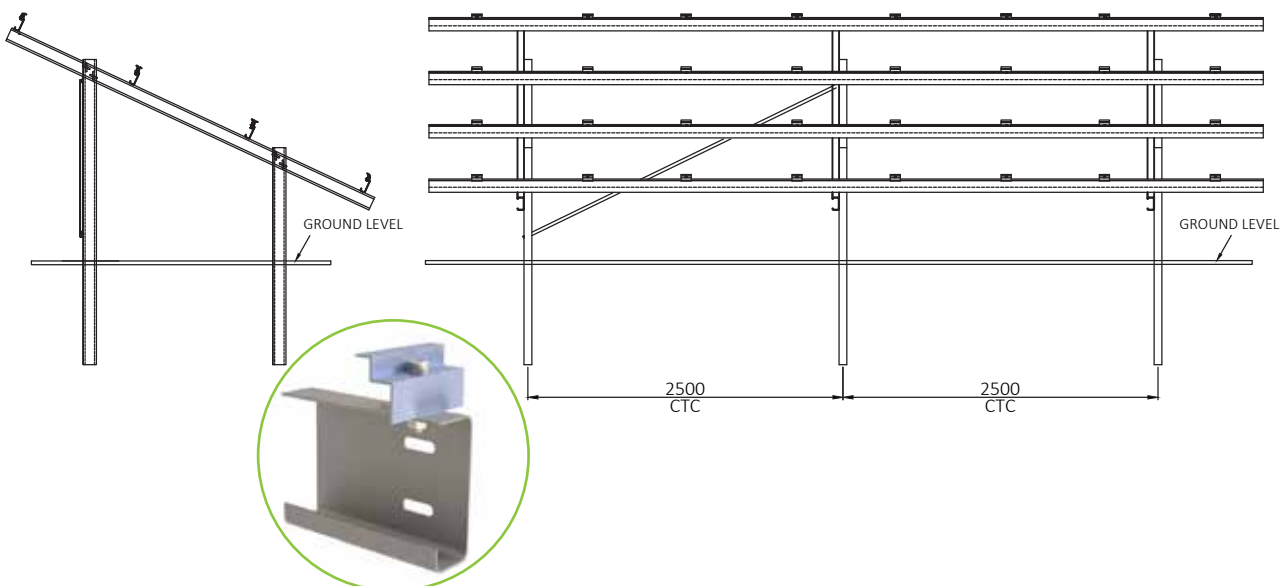

PSI PLATINUM

Double Pile Triple Landscape Mounting Systems with Aluminum Purlins



System Arrangement

- This mounting system can be produced and installed in the tables of total length of 12m, 24m & 48m.
- For large scale projects customization of tables could be done.
- The Steel grade used is as per EN 10025 & Hot dip galvanizing to BS EN ISO 1461 : 1999 & Aluminum AA 6063 T6
- The fasteners are used as per CLASS A2 - 70.
- The Inclination / Tilt angle depends on the latitude.
- The distance between the horizontal purlins will be according to the panel dimensions.
- TUV Certified Mounting Systems.

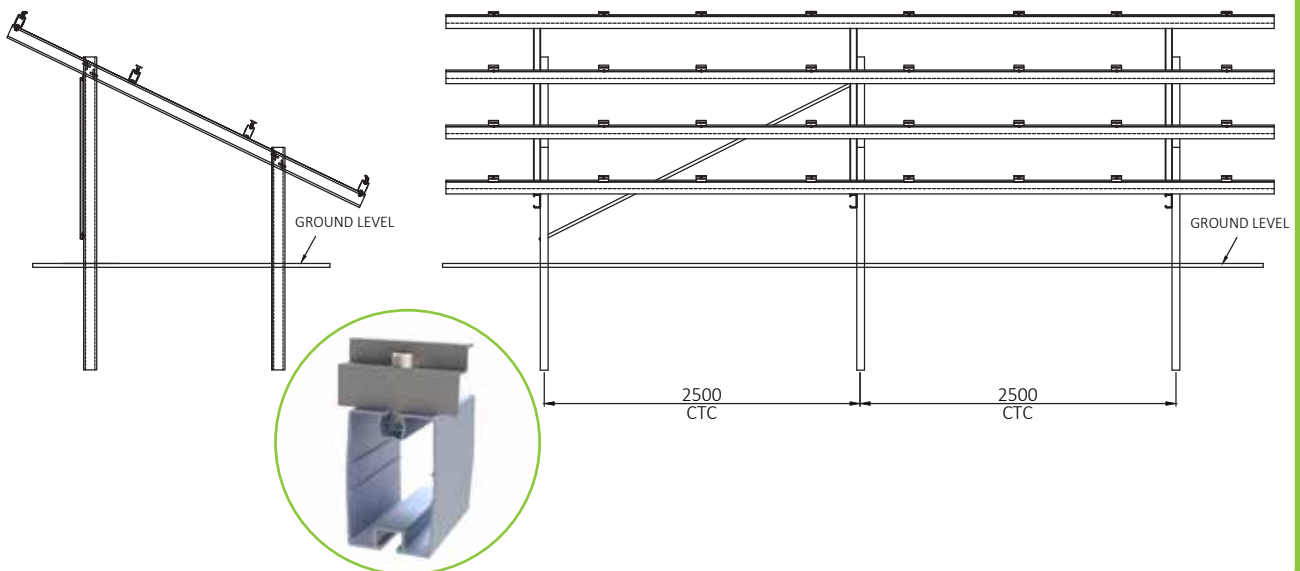

GROUND MOUNTED SYSTEMS

Profile Details & System Advantages

The above structures are ideal for field installations. The Single & Double Pile can be adjusted to all module types and foundations, such as poles, ground screws and concrete slabs.

They are simple to assemble and provide high resistance to wind loads according to Euro Codes 1, 3, 8 and 9 and Dubai Municipality Seismic Design Loads.

Advantages:

- Simple Structure – Easy to install
- High Stability
- Economical Solution
- Quick Installation
- Easy Alignment
- Pile is used as the structure's pole to insure stability
- Can be customized as per the string size
- TUV Certified Systems

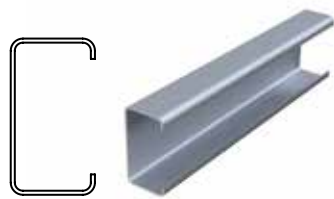

PILE



BEAM



PURLIN



PURLIN

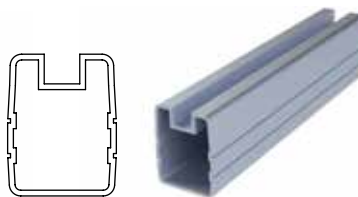

PURLIN CORE JOINT

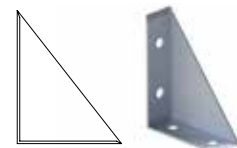

GUSSET JOINT

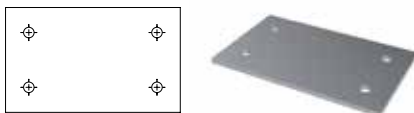

PURLIN CONNECTION PLATE



DIAGONAL MEMBER



DIAGONAL CONNECTION



TRANSVERSE SEISMIC



MID CLAMP

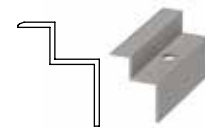

END CLAMP



Engineered to Excellence

EDITION 2017

PSI OMEGA

Single Portrait Mounting Systems - Elevated Ballast



System Arrangement

- This mounting system can be designed and installed as per the available Roof Top area.
- For large scale projects customization of tables could be done.
- The Aluminum grade used is AA 6063 T6 with Silver Matt Anodising up to 15 - 18 microns.
- The fasteners are used as per CLASS A2 - 70
- The Inclination / Tilt angle depends on the latitude.
- The distance between the horizontal purlins will be according to the panel dimensions.
- TUV Certified Mounting Systems.

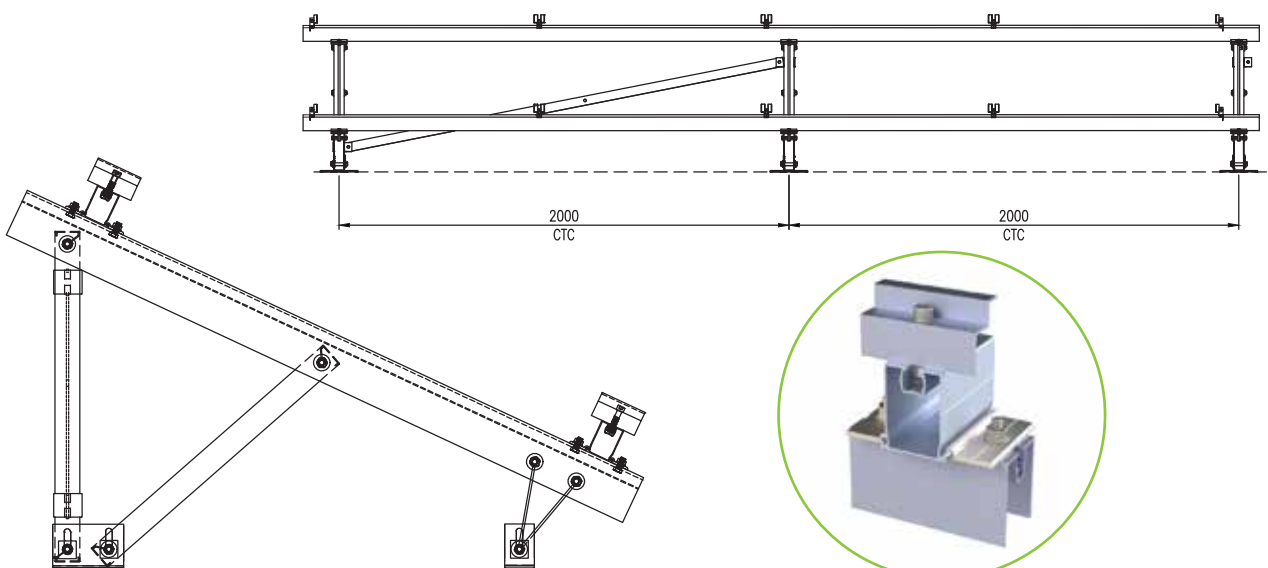

PSI CORONA

Double Portrait Mounting Systems - Elevated Ballast



System Arrangement

- This mounting system can be designed and installed as per the available Roof Top area.
- For large scale projects customization of tables could be done.
- The Aluminum grade used is AA 6063 T6 with Silver Matt Anodising up to 15 - 18 microns.
- The fasteners are used as per CLASS A2 - 70
- The Inclination / Tilt angle depends on the latitude.
- The distance between the horizontal purlins will be according to the panel dimensions.
- TUV Certified Mounting Systems.

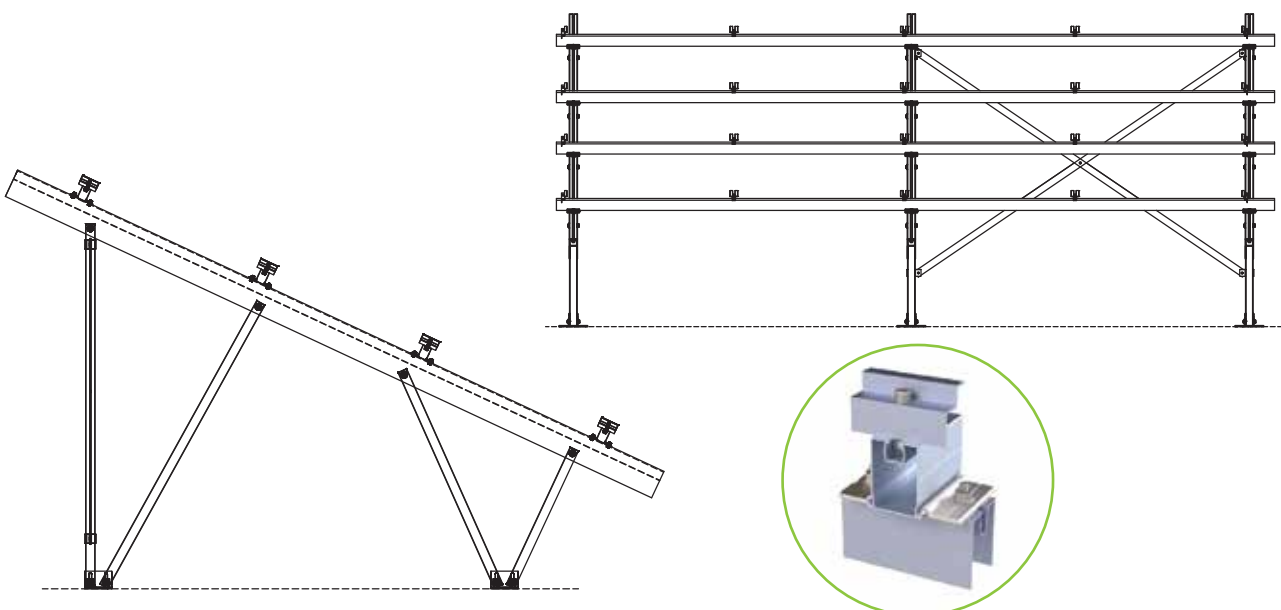

PSI OPAL

Single Landscape Mounting Systems - Elevated Ballast

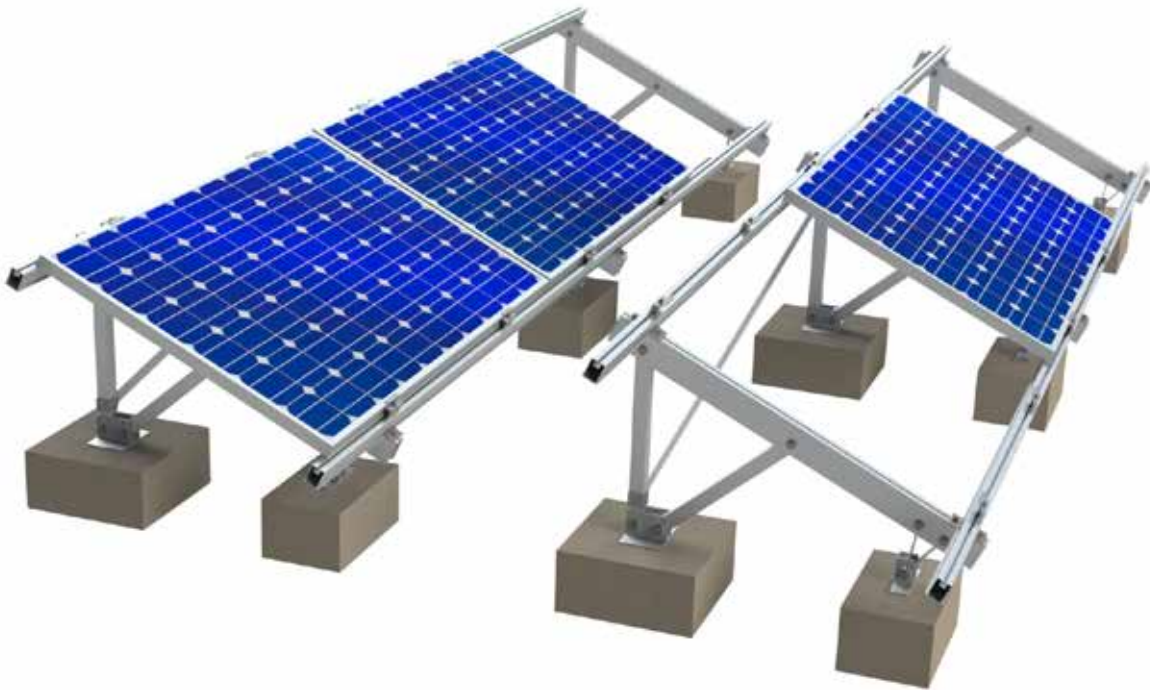

System Arrangement

- This mounting system can be designed and installed as per the available Roof Top area.
- For large scale projects customization of tables could be done.
- The Aluminum grade used is AA 6063 T6 with Silver Matt Anodising up to 15 - 18 microns.
- The fasteners are used as per CLASS A2 - 70
- The Inclination / Tilt angle depends on the latitude.
- The distance between the horizontal purlins will be according to the panel dimensions.
- TUV Certified Mounting Systems.

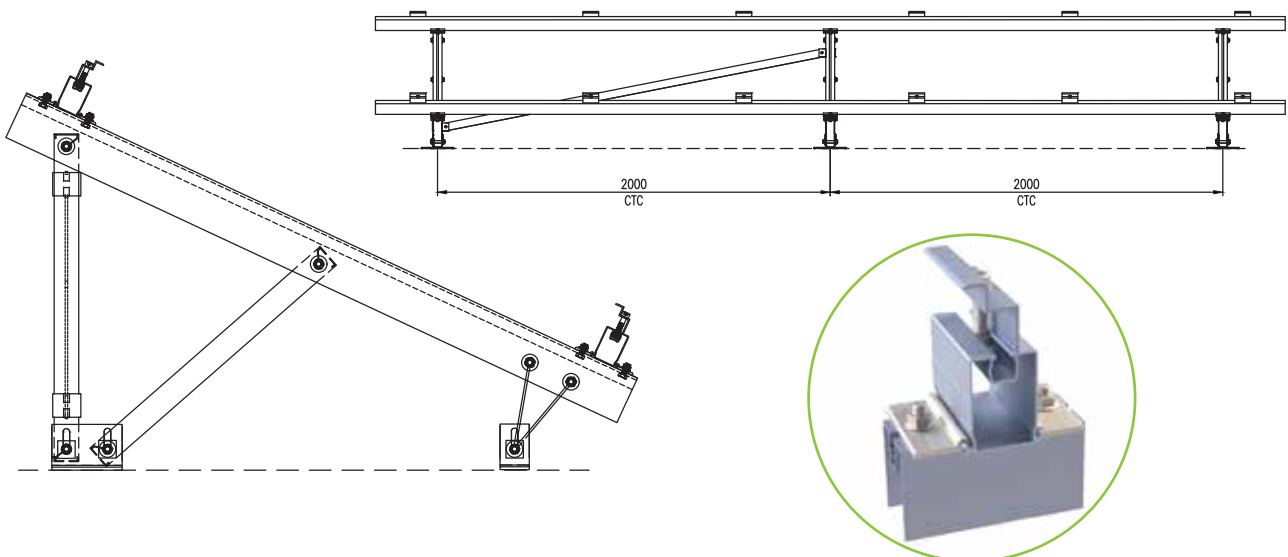

PSI PEARL

Triple Landscape Mounting Systems - Elevated Ballast



System Arrangement

- This mounting system can be designed and installed as per the available Roof Top area.
- For large scale projects customization of tables could be done.
- The Aluminum grade used is AA 6063 T6 with Silver Matt Anodising up to 15 - 18 microns.
- The fasteners are used as per CLASS A2 - 70
- The Inclination / Tilt angle depends on the latitude.
- The distance between the horizontal purlins will be according to the panel dimensions.
- TUV Certified Mounting Systems.

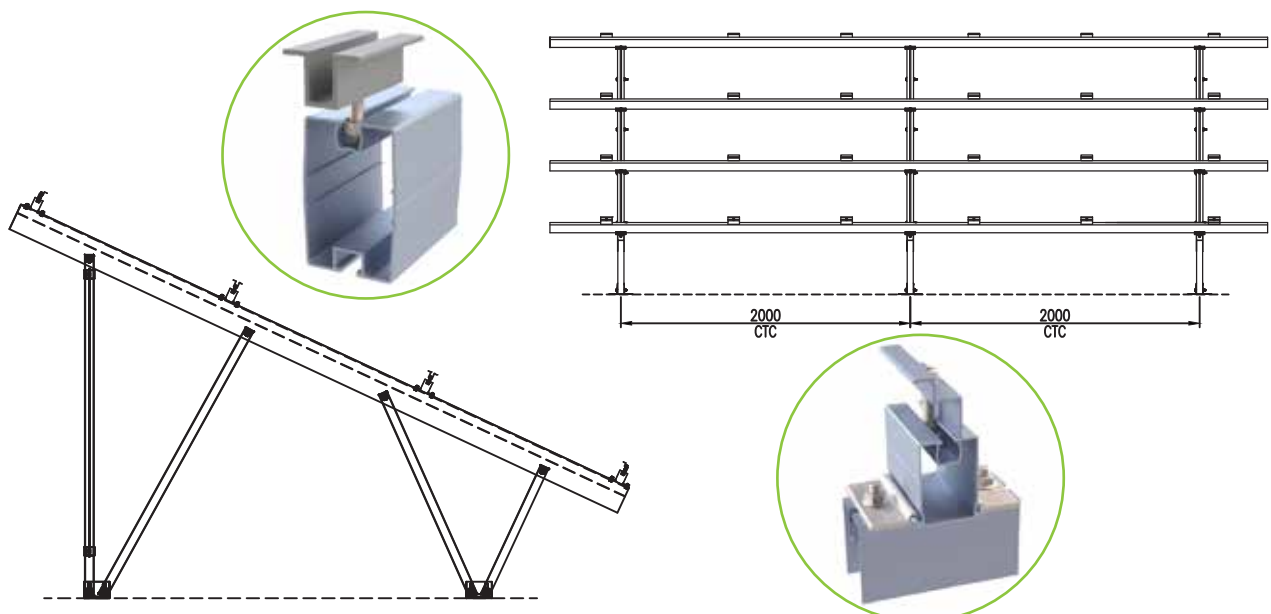

FLAT ROOF MOUNTED SYSTEMS

PSI CORAL

Single Portrait Mounting Systems - With Ballast



System Arrangement

- This mounting system can be designed and installed as per the available Roof Top area.
- For large scale projects customization of tables could be done.
- The Aluminum grade used is AA 6063 T6 with Silver Matt Anodising up to 15 - 18 microns.
- The fasteners are used as per CLASS A2 - 70
- The Inclination / Tilt angle depends on the latitude.
- The distance between the horizontal purlins will be according to the panel dimensions.
- TUV Certified Mounting Systems.

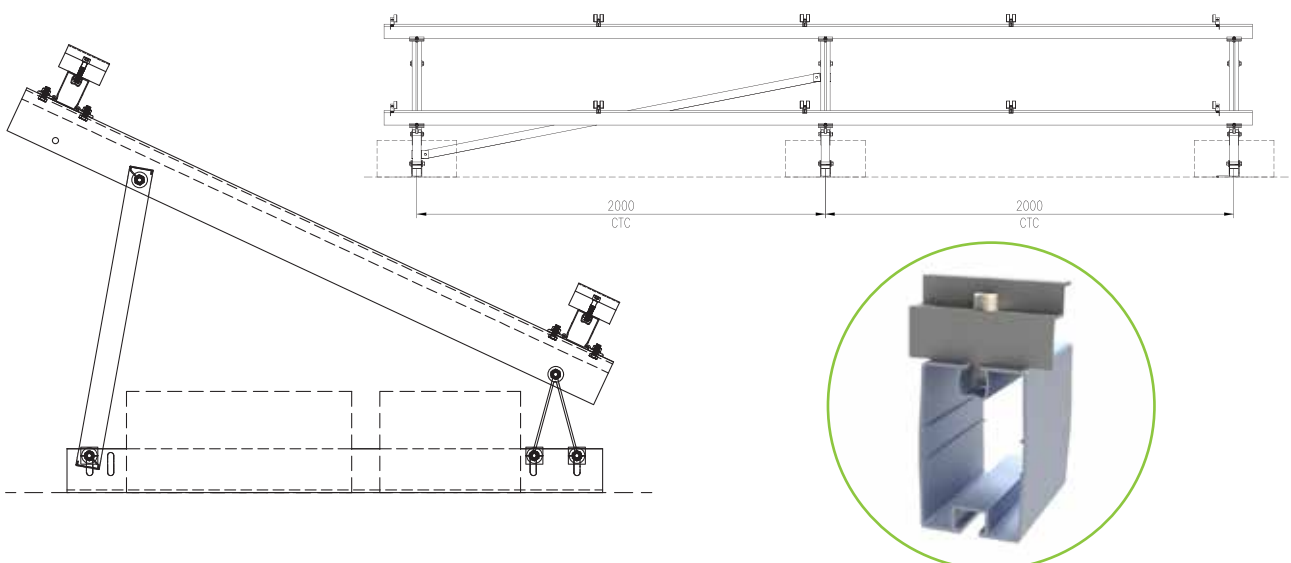

PSI ATLAS

Single Landscape Mounting Systems - With Ballast



System Arrangement

- This mounting system can be designed and installed as per the available Roof Top area.
- For large scale projects customization of tables could be done.
- The Aluminum grade used is AA 6063 T6 with Silver Matt Anodising up to 15 - 18 microns.
- The fasteners are used as per CLASS A2 - 70
- The Inclination / Tilt angle depends on the latitude.
- The distance between the horizontal purlins will be according to the panel dimensions.
- TUV Certified Mounting Systems.

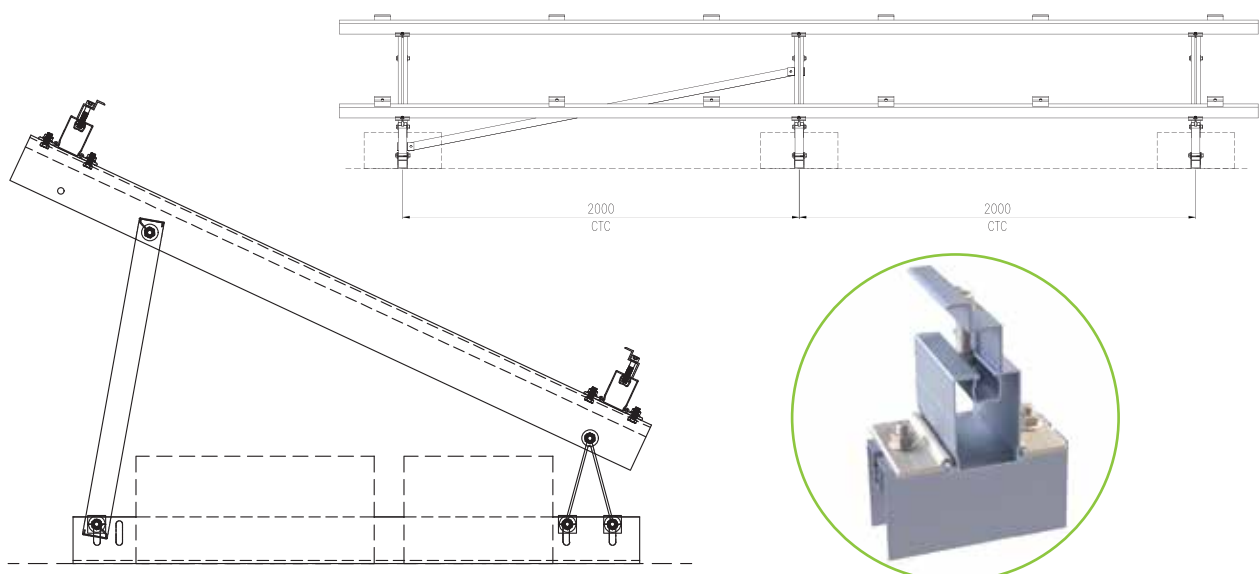

FLAT ROOF MOUNTED SYSTEMS

Profile Details & System Advantages

The above structures are ideal for Roof Top installations.

They are simple to assemble and provide high resistance to wind loads according to Euro Codes 1, 3, 8 and 9 and Dubai Municipality Seismic Design Loads.

Advantages:

- Simple Structure – Easy to install
- High Stability
- Economical Solution
- Quick Installation
- Easy Alignment
- Can be customized as per the string size
- TUV Certified Systems

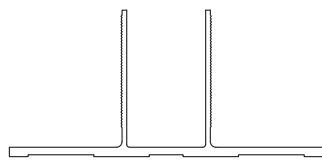

BASE

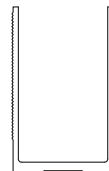

BASE RAIL

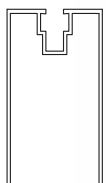

BEAM



BEAM

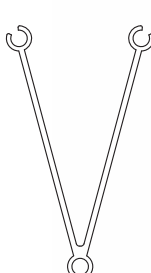

V MEMBER



VERTICAL SUPPORT



SOLAR PHOTOVOLTAIC MOUNTING SYSTEM

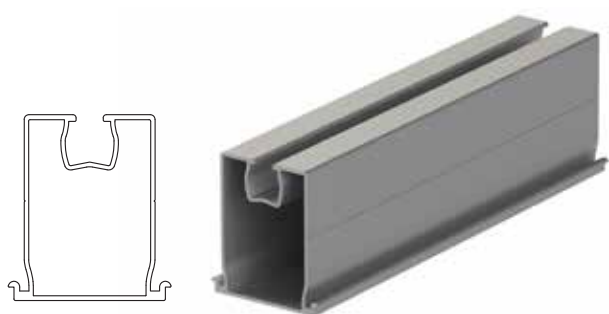

PURLIN



PURLIN JOINT



LOCK CLAMP LEFT

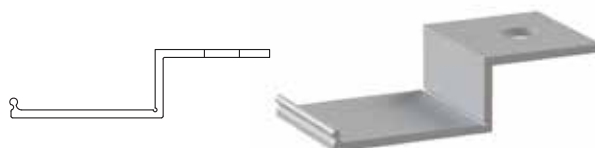

LOCK CLAMP RIGHT



PURLIN CLAMP

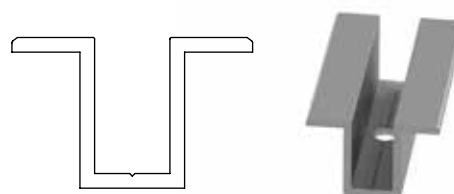

MID CLAMP

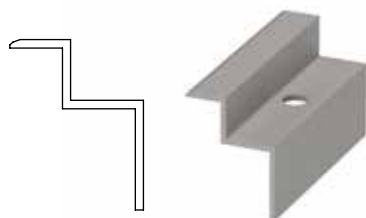

END CLAMP

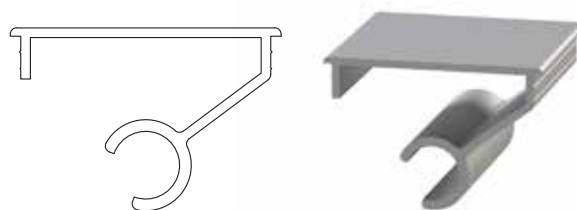

COVER CLAMP

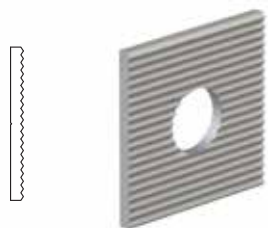

SPLINE WASHER



FLAT MEMBER



BALLAST



BALLAST

PSI MERCURY

Single Landscape Low Height Mounting Systems - With Ballast

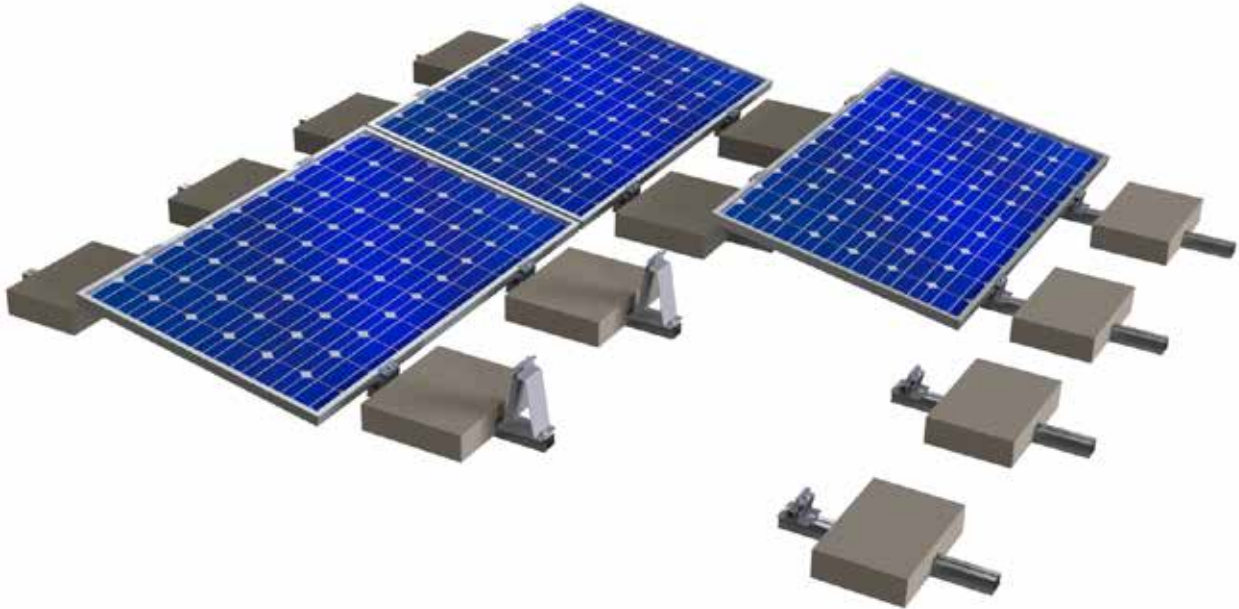

System Arrangement

- This mounting system can be designed and installed as per the available Roof Top area.
- For large scale projects customization of tables could be done.
- The Aluminum grade used is AA 6063 T6 with Silver Matt Anodising up to 15 - 18 microns.
- The fasteners are used as per CLASS A2 - 70.
- This is a low height 10 Degrees System.
- The distance between the two rows will be according to the panel dimensions.
- TUV Certified Mounting Systems.

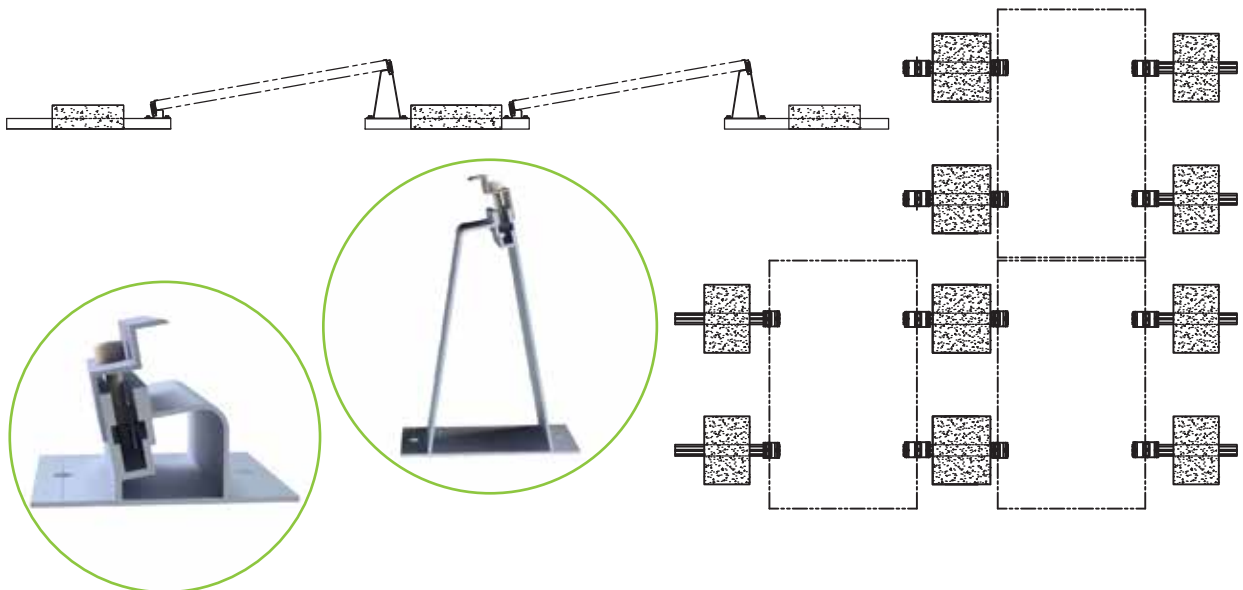

PSI HYDRA

East West Single Landscape Low Height Mounting Systems - With Ballast



System Arrangement

- This mounting system can be designed and installed as per the available Roof Top area.
- For large scale projects customization of tables could be done.
- The Aluminum grade used is AA 6063 T6 with Silver Matt Anodising up to 15 - 18 microns.
- The fasteners are used as per CLASS A2 - 70.
- This is the East West low height 10 Degrees System.
- The distance between the two rows will be according to the panel dimensions.
- TUV Certified Mounting Systems.

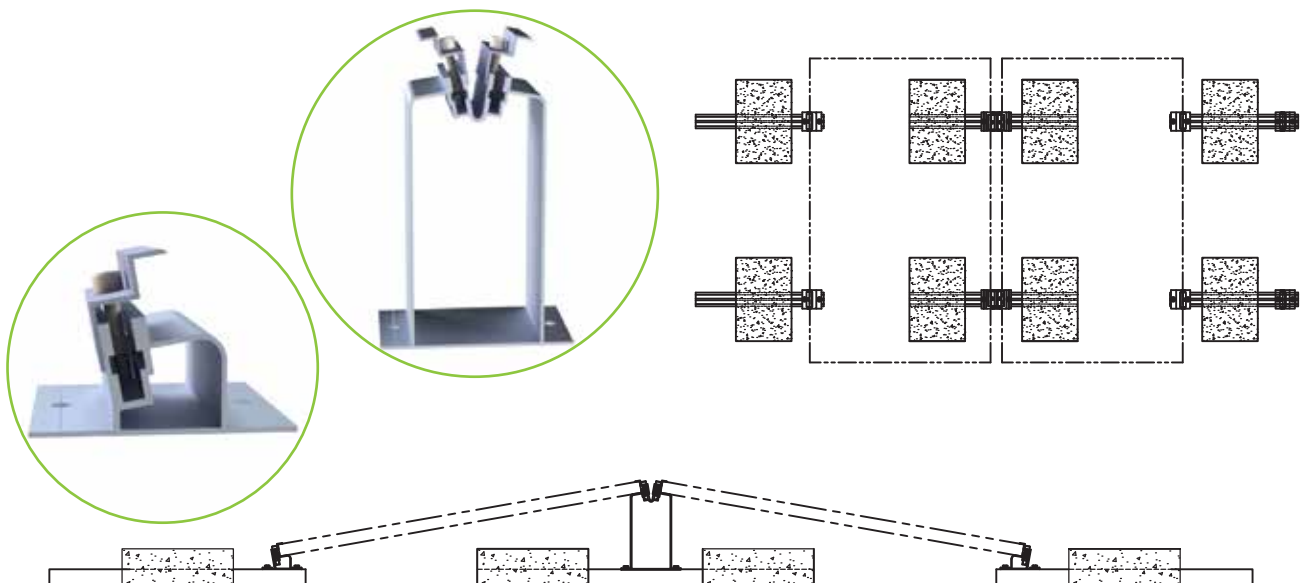

FLAT ROOF LOW HEIGHT MOUNTED SYSTEMS

Profile Details & System Advantages

The above structures are ideal for Roof Top installations.

They are simple to assemble and provide high resistance to wind loads according to Euro Codes 1, 3, 8 and 9 and Dubai Municipality Seismic Design Loads.

Advantages:

- Simple Structure – Easy to install
- High Stability
- Economical Solution
- Quick Installation
- Base Rail ensures perfect and proper alignment
- Non Penetrative System
- The System can be relocated
- TUV Certified Systems

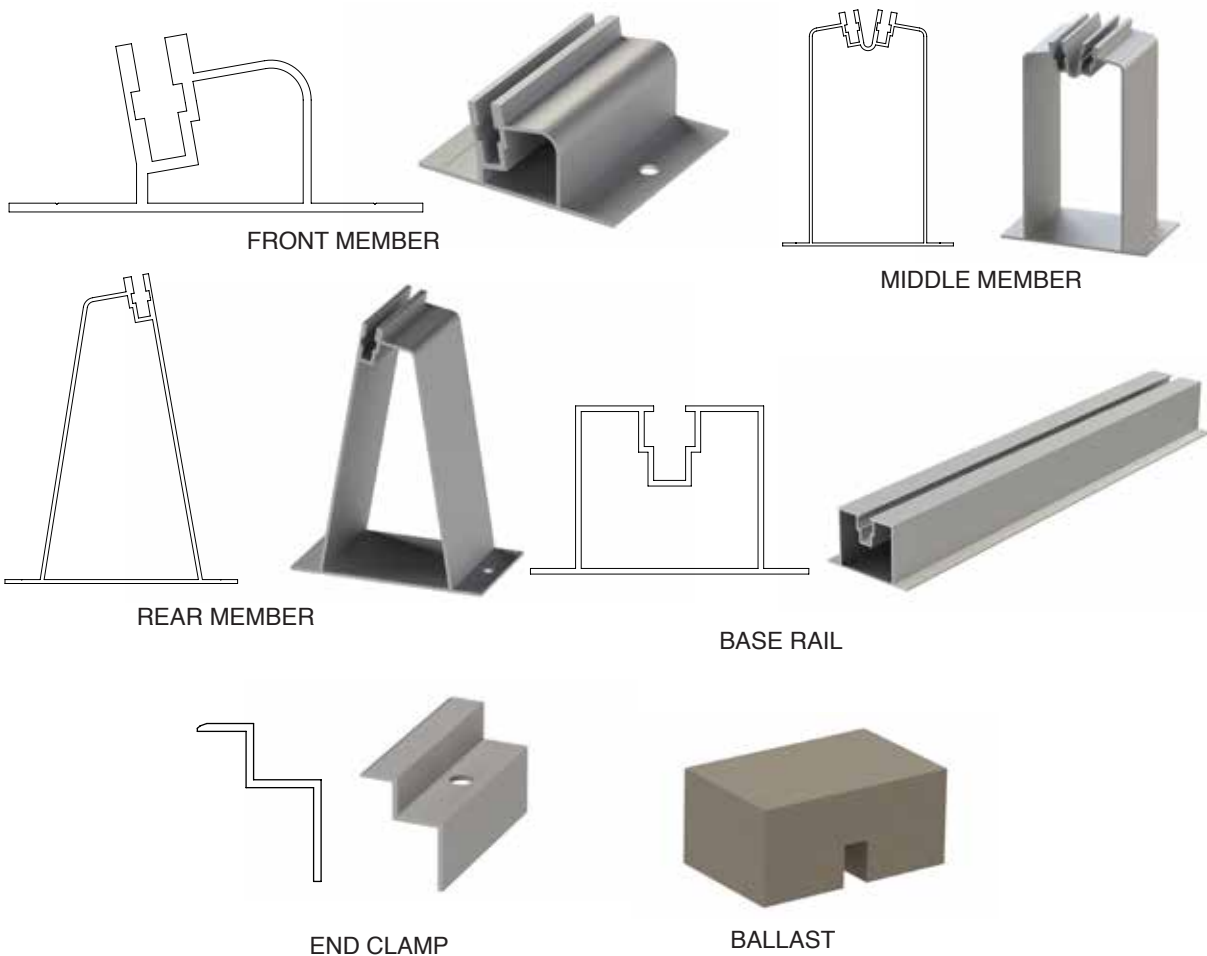



Engineered to Excellence

EDITION 2017

PSI ASTRO

ECO Portrait System

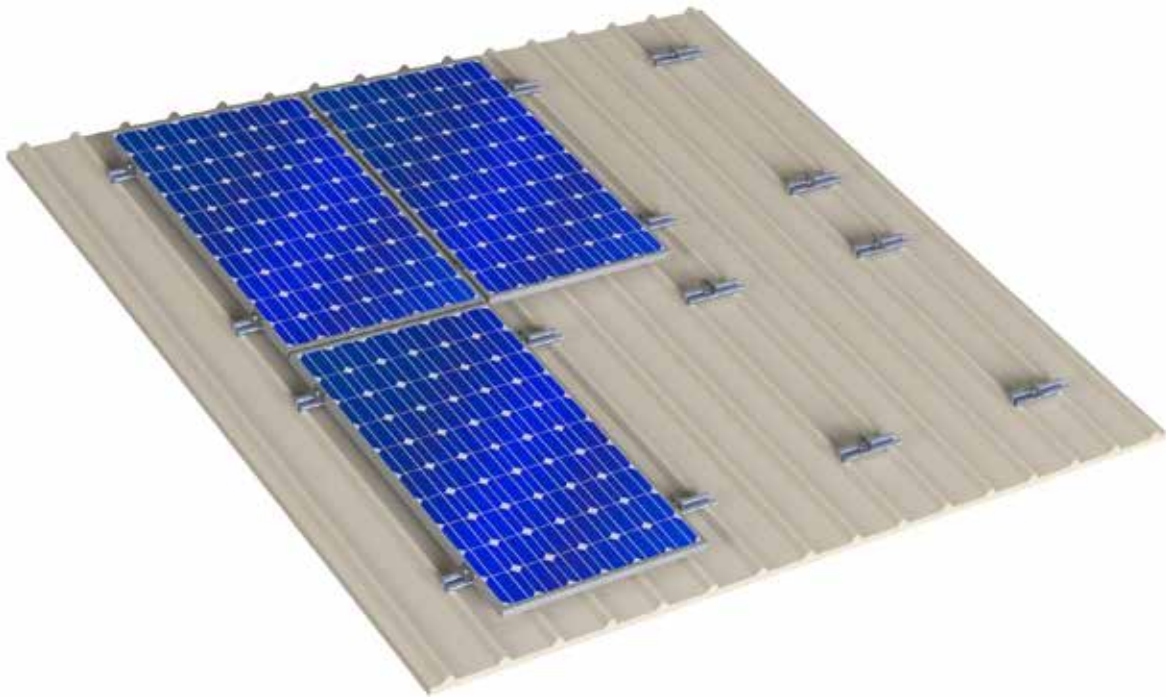

System Arrangement

- This mounting system can be designed and installed parallel to the Roof Top.
- For large scale projects customization of tables could be done.
- The Aluminum grade used is AA 6063 T6 with Silver Matt Anodising up to 15 - 18 microns.
- The fasteners are used as per CLASS A2 - 70.
- The Vertical distance is defined by the module dimensions of the Solar PV System.
- The Horizontal distance is defined by the type of the corrugated metal sheet and the type of the panel.
- This is a economical solution ideal for rapid installation on Portrait Orientation.
- TUV Certified Mounting Systems.

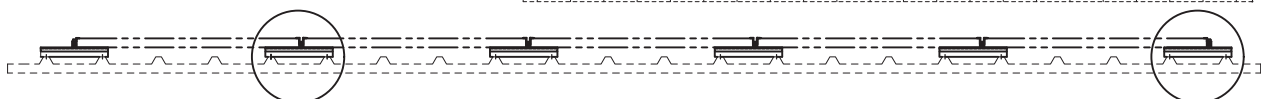
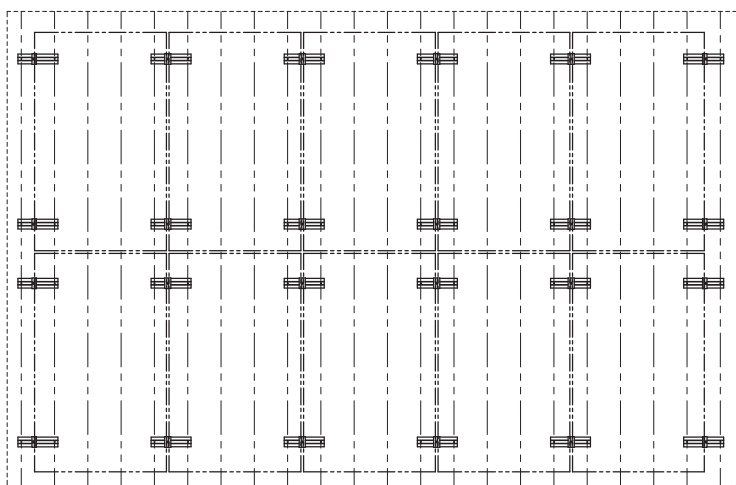
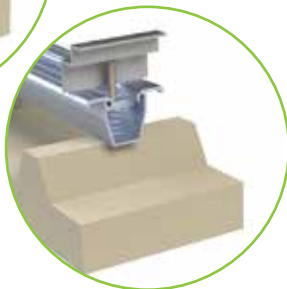
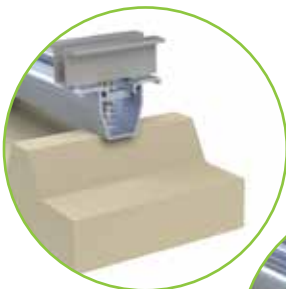

PSI ASTRO

ECO Landscape System



System Arrangement

- This mounting system can be designed and installed parallel to the Roof Top.
- For large scale projects customization of tables could be done.
- The Aluminum grade used is AA 6063 T6 with Silver Matt Anodising up to 15 - 18 microns.
- The fasteners are used as per CLASS A2 - 70.
- The Vertical distance is defined by the module dimensions of the Solar PV System.
- The Horizontal distance is defined by the type of the corrugated metal sheet and the type of the panel.
- This is a economical solution ideal for rapid installation on Landscape Orientation.
- TUV Certified Mounting Systems.

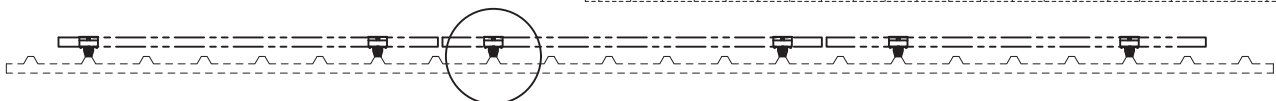
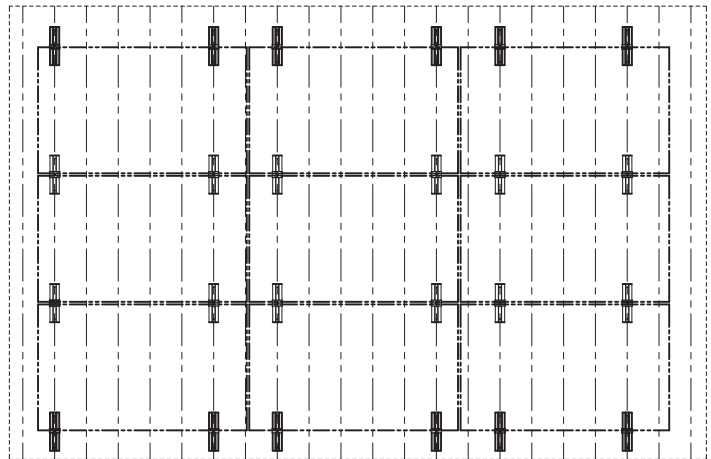
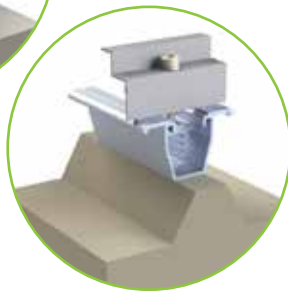
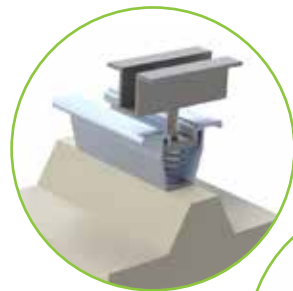

PSI GALAXY

Rail Portrait System

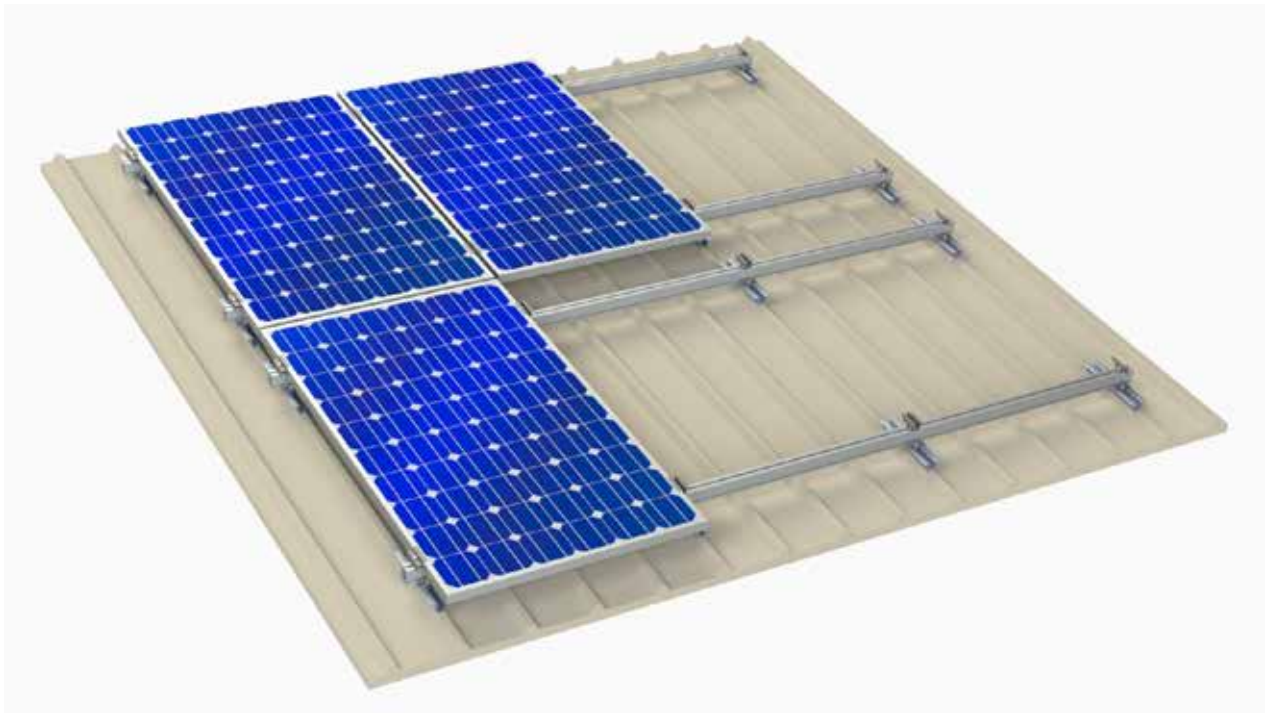

System Arrangement

- This mounting system can be designed and installed parallel to the Roof Top.
- For large scale projects customization of tables could be done.
- The Aluminum grade used is AA 6063 T6 with Silver Matt Anodising up to 15 - 18 microns.
- The fasteners are used as per CLASS A2 - 70.
- The Vertical distance is defined by the module dimensions of the Solar PV System.
- The Horizontal distance is defined by the type of the corrugated metal sheet and the type of the panel.
- The installation of the Base and Rail permits better air circulation and easy alignment on portrait orientation.
- TUV Certified Mounting Systems.

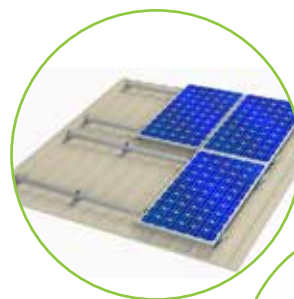
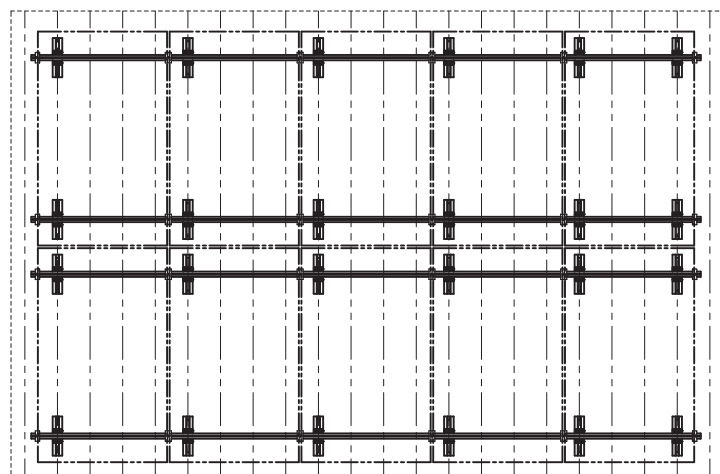

PSI GALAXY

Rail Landscape System



System Arrangement

- This mounting system can be designed and installed parallel to the Roof Top.
- For large scale projects customization of tables could be done.
- The Aluminum grade used is AA 6063 T6 with Silver Matt Anodising up to 15 - 18 microns.
- The fasteners are used as per CLASS A2 - 70.
- The Vertical distance is defined by the purlin spacing of the Super Structure of the building.
- The Horizontal distance is defined by the type of the corrugated metal sheet and the type of the panel.
- The installation of the Base and Rail permits better air circulation and easy alignment on portrait orientation.
- TUV Certified Mounting Systems.

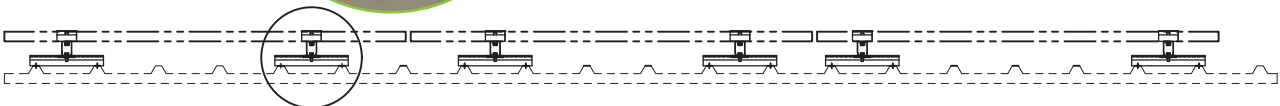
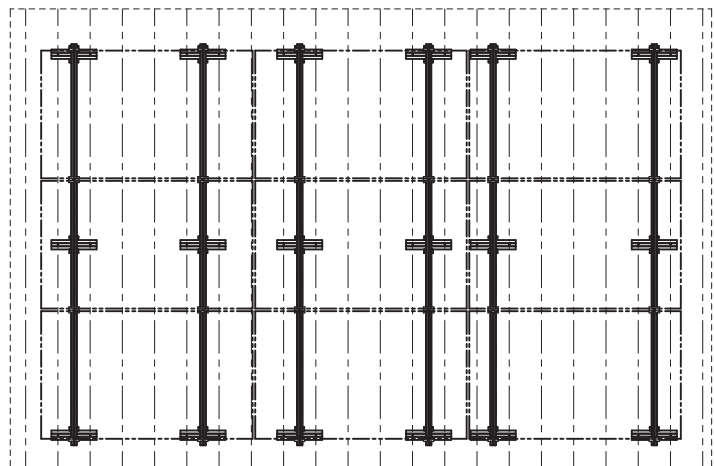
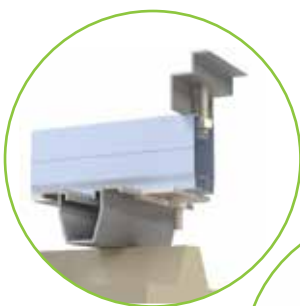

PSI SIGMA

Cross Rail Portrait System

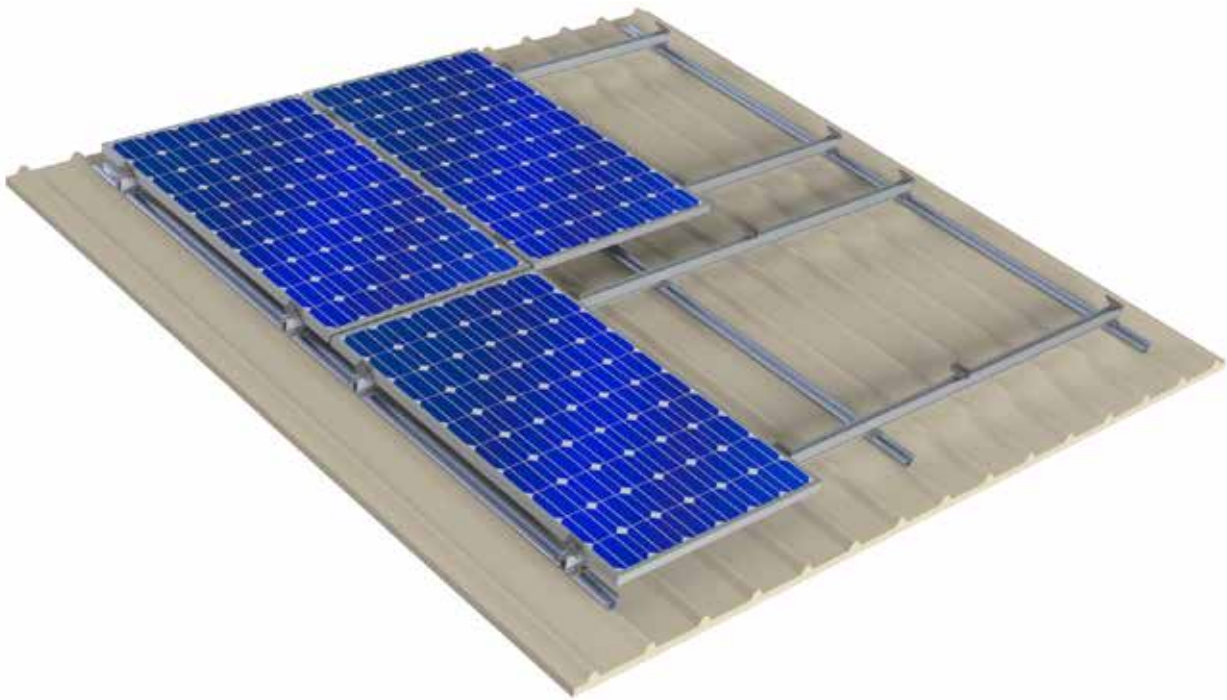

System Arrangement

- This mounting system can be designed and installed parallel to the Roof Top.
- For large scale projects customization of tables could be done.
- The Aluminum grade used is AA 6063 T6 with Silver Matt Anodising up to 15 - 18 microns.
- The fasteners are used as per CLASS A2 - 70.
- The Vertical distance is defined by the module dimensions of the Solar PV System.
- The Horizontal distance is defined by the type of the corrugated metal sheet and the type of the panel.
- The installation of the Base and Rail permits better air circulation and easy alignment on portrait orientation.
- TUV Certified Mounting Systems.

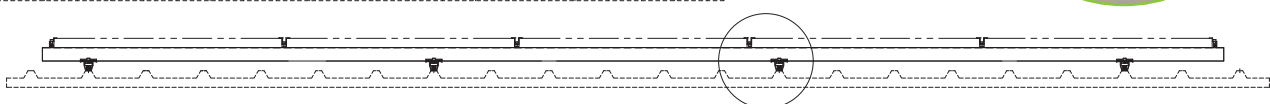
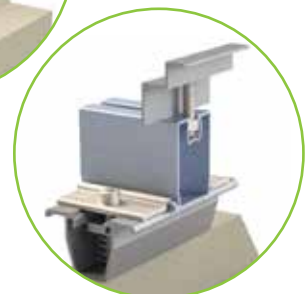
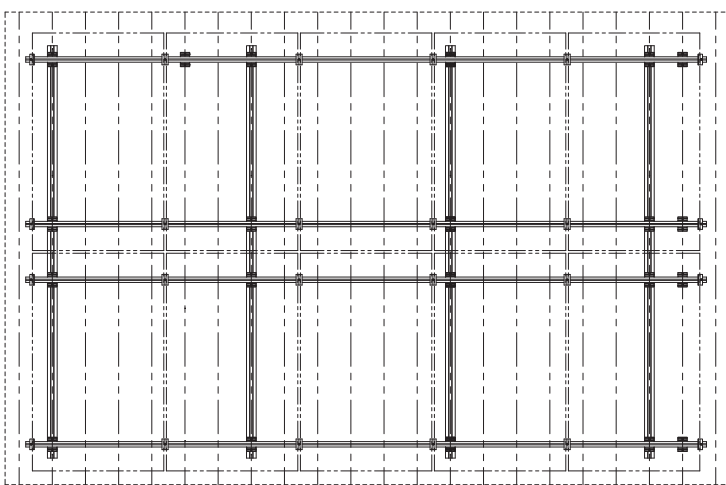

PSI SIGMA

Cross Rail Landscape System

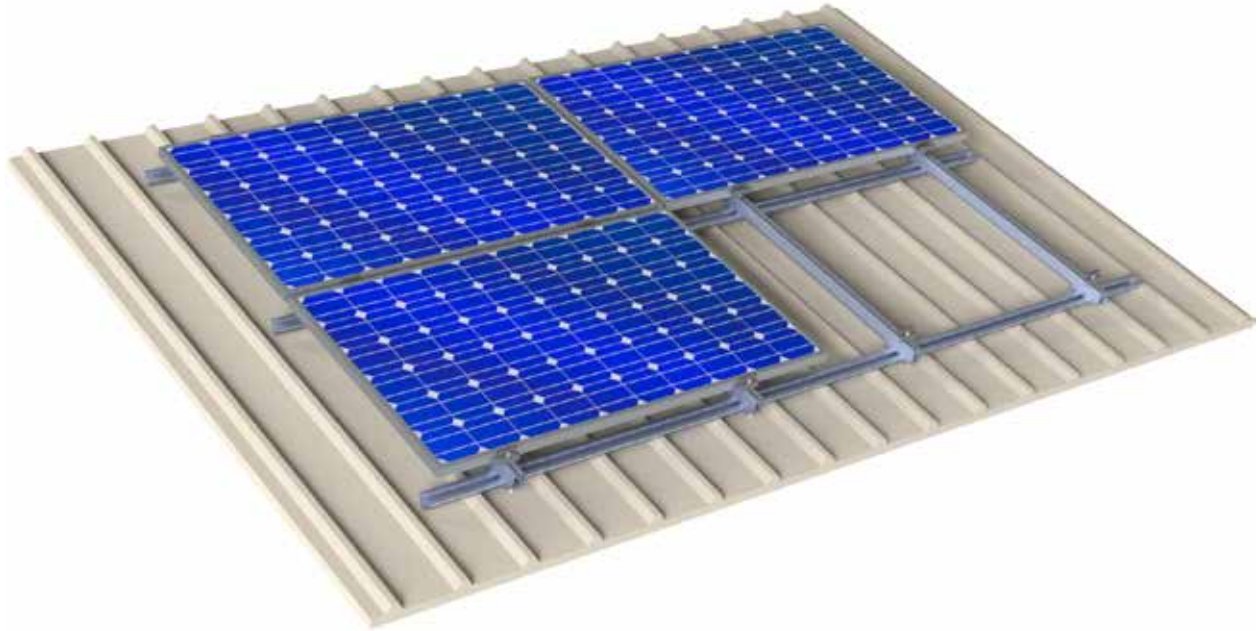

System Arrangement

- This mounting system can be designed and installed parallel to the Roof Top.
- For large scale projects customization of tables could be done.
- The Aluminum grade used is AA 6063 T6 with Silver Matt Anodising up to 15 - 18 microns.
- The fasteners are used as per CLASS A2 - 70.
- The Vertical distance is defined by the purlin spacing of the Super Structure of the building.
- The Horizontal distance is defined by the type of the corrugated metal sheet and the type of the panel.
- The installation of the Base and Rail permits better air circulation and easy alignment on portrait orientation.
- TUV Certified Mounting Systems.

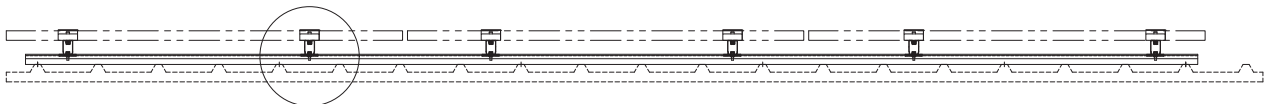
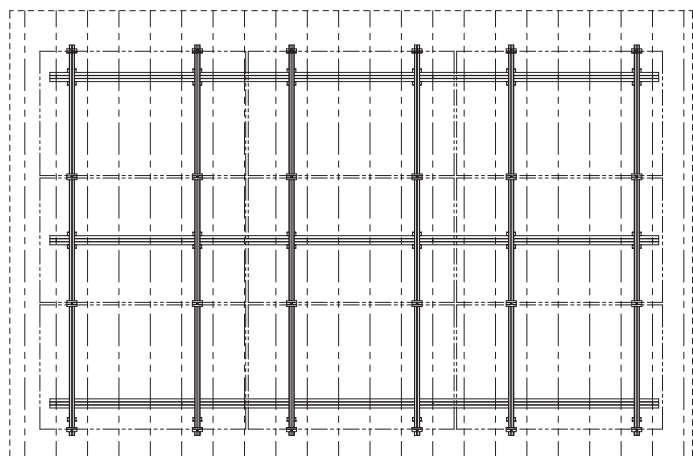

PSI ALPHA

Single V Rail Portrait System

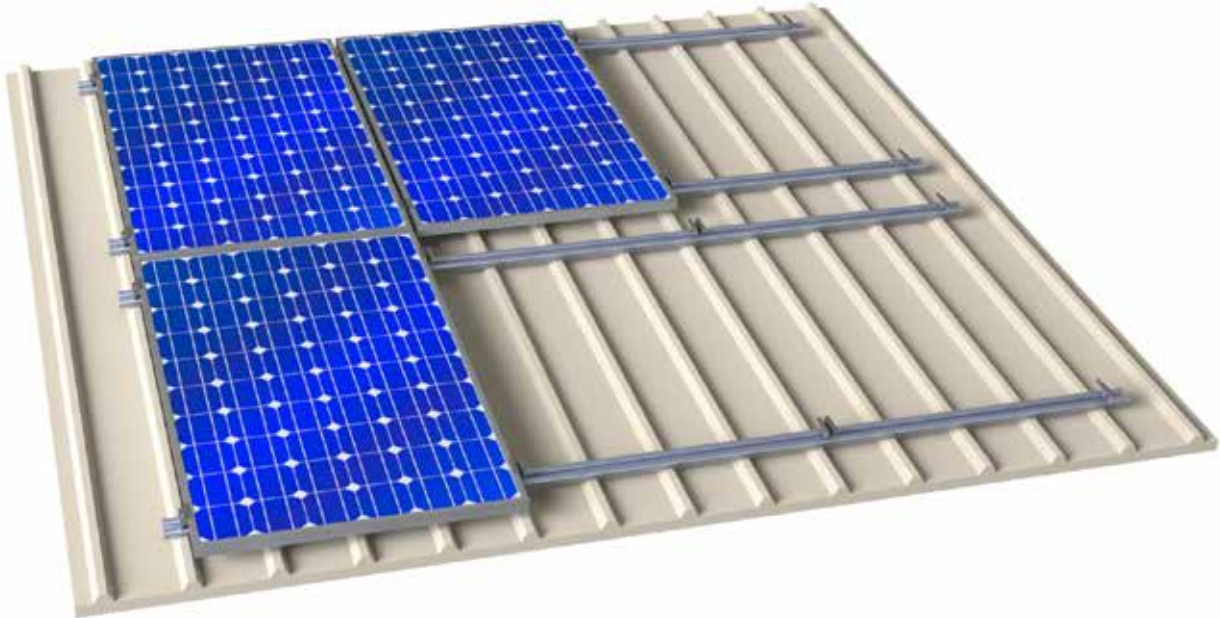

System Arrangement

- This mounting system can be designed and installed parallel to the Roof Top.
- For large scale projects customization of tables could be done.
- The Aluminum grade used is AA 6063 T6 with Silver Matt Anodising up to 15 - 18 microns.
- The fasteners are used as per CLASS A2 - 70.
- The Vertical distance is defined by the module dimensions of the Solar PV System.
- The installation of the Horizontal Rail permits rapid installation on portrait orientation.
- TUV Certified Mounting Systems.

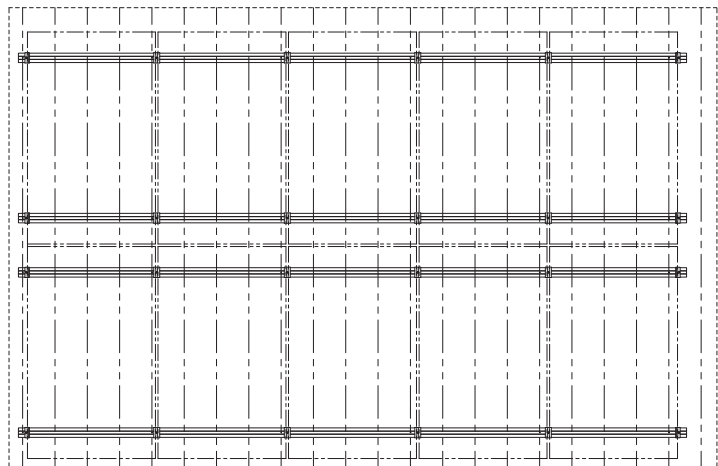

PSI ALPHA

Single V Rail Landscape System



System Arrangement

- This mounting system can be designed and installed parallel to the Roof Top.
- For large scale projects customization of tables could be done.
- The Aluminum grade used is AA 6063 T6 with Silver Matt Anodising up to 15 - 18 microns.
- The fasteners are used as per CLASS A2 - 70.
- The Horizontal distance is defined by the type of the corrugated metal sheet and the type of the panel.
- The installation of the Vertical Rail permits rapid installation on Landscape orientation.
- TUV Certified Mounting Systems.

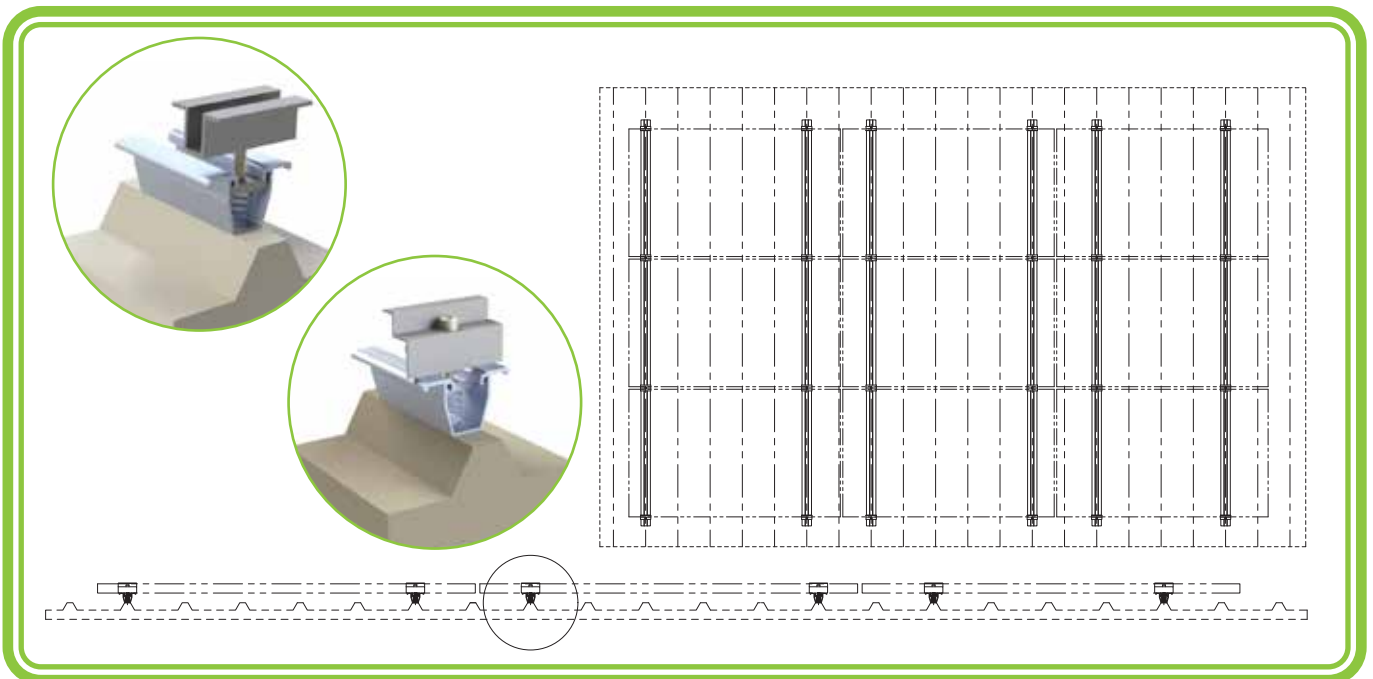

PSI HYDER

Standing Seam Portrait System



System Arrangement

- This mounting system can be used for Standing seam, Round seam and Angle seam roofs without roof penetration.
- This is an economical solution ideal for the rapid installation on Portrait Orientation.
- The Aluminum grade used is AA6063 T6 with Silver Matt Anodizing up to 15-18 microns.
- The fasteners are used as per CLASS A2 – 70.
- The Vertical distance is defined by the module dimensions of the Solar PV System.
- The horizontal distance is defined by the type of standing seam profile and the type of the panel.
- The installation of the Clamp and Rail permits better air circulation and easy alignment for portrait orientation.

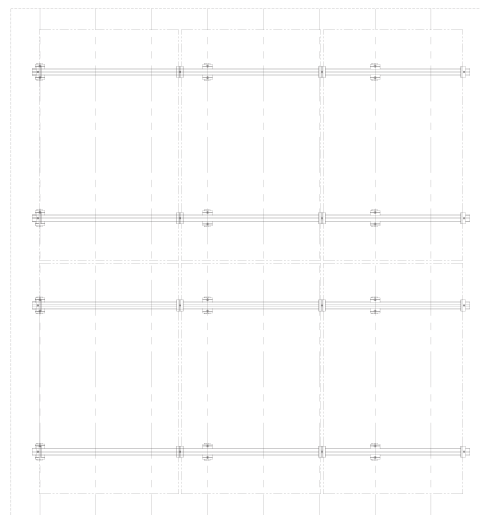
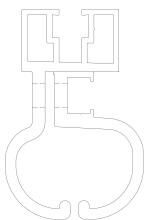

PSI HYDER

Standing Seam Landscape System



System Arrangement

- This mounting system can be used for Standing seam, Round seam and Angle seam roofs without roof penetration.
- This is an economical solution ideal for the rapid installation on Landscape Orientation.
- The Aluminum grade used is AA6063 T6 with Silver Matt Anodizing up to 15-18 microns.
- The fasteners are used as per CLASS A2 – 70.
- The Vertical distance is defined by the module dimensions of the Solar PV System.
- The horizontal distance is defined by the type of standing seam profile and the type of the panel.

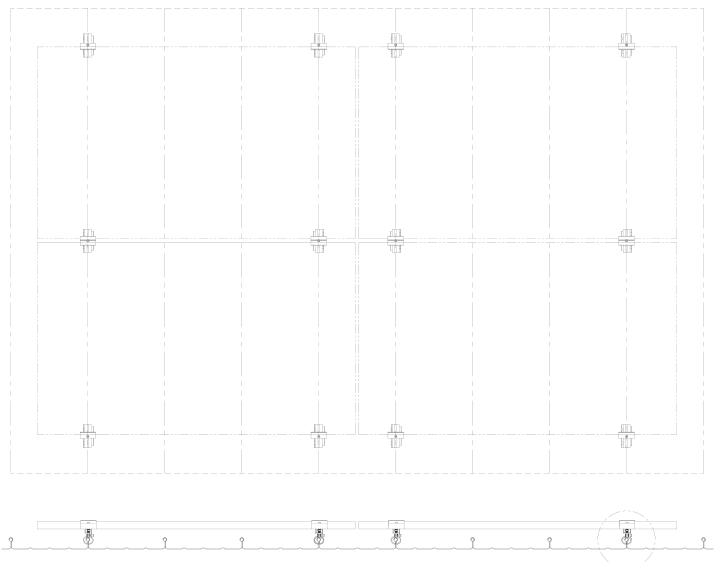
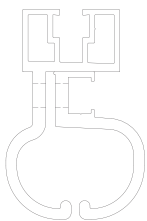
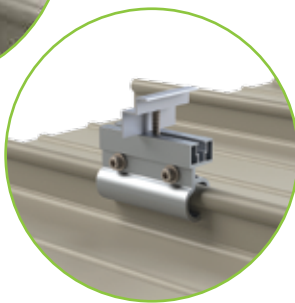

PSI KOLHAI

Standing Seam Low Height Double Landscape System



System Arrangement

- This mounting system can be used for Standing seam, Round seam and Angle seam roofs without roof penetration.
- This is an economical solution ideal for the rapid installation on Landscape Orientation.
- The Aluminum grade used is AA6063 T6 with Silver Matt Anodizing up to 15-18 microns.
- The fasteners are used as per CLASS A2 – 70.
- The Vertical distance is defined by the module dimensions of the Solar PV System.
- The horizontal distance is defined by the type of standing seam profile and the type of the panel.

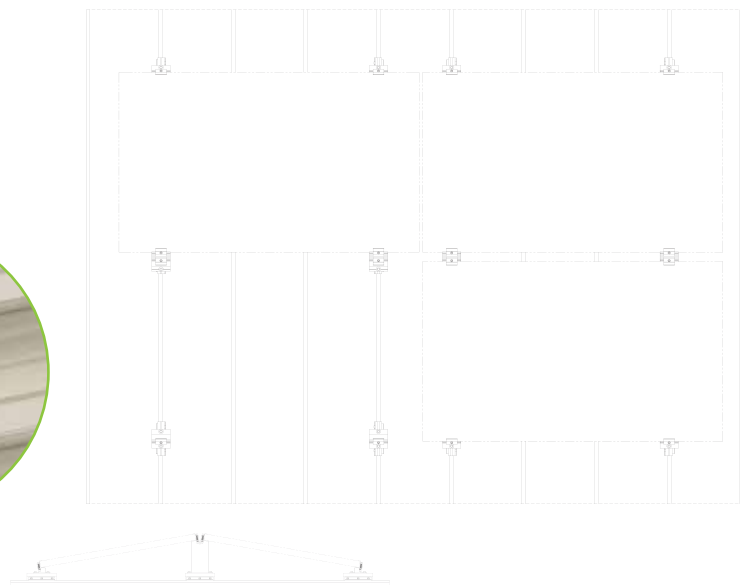
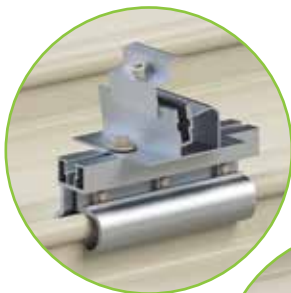

PSI ZABARVAN

Standing Seam Low Height Single Landscape System



System Arrangement

- This mounting system can be used for Standing seam, Round seam and Angle seam roofs without roof penetration.
- This is an economical solution ideal for the rapid installation on Landscape Orientation.
- The Aluminum grade used is AA6063 T6 with Silver Matt Anodizing up to 15-18 microns.
- The fasteners are used as per CLASS A2 – 70.
- The Vertical distance is defined by the module dimensions of the Solar PV System.
- The horizontal distance is defined by the type of standing seam profile and the type of the panel.

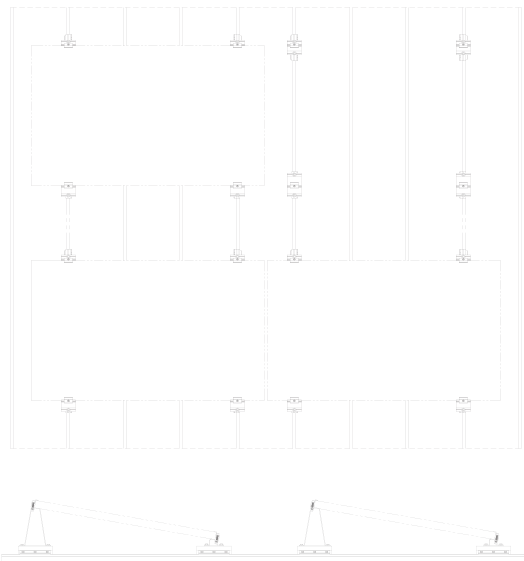
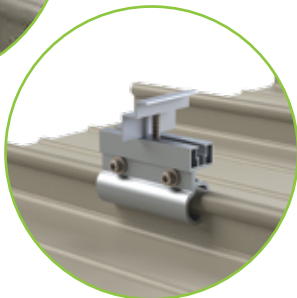

INDUSTRIAL ROOF MOUNTED SYSTEMS

Profile Details & System Advantages

The above structures are ideal for Roof Top installations.

They are simple to assemble and provide high resistance to wind loads according to Euro Codes 1, 3, 8 and 9 and Dubai Municipality Seismic Design Loads.

Advantages:

- Simple Structure – Easy to install
- High Stability
- Economical Solution
- Quick Installation
- Easy alignment
- Provision of EPDM Sheet and Sealant ensures leak proof system
- The System can be relocated
- TUV Certified Systems

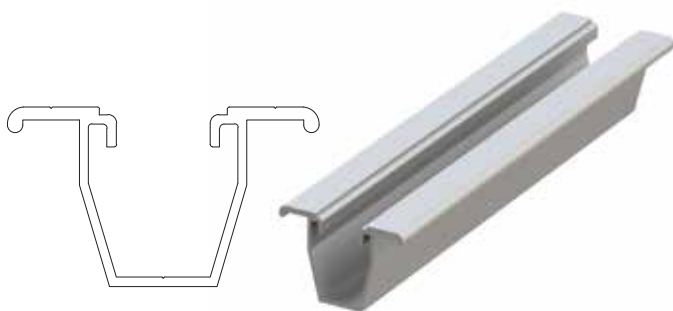

V RAIL

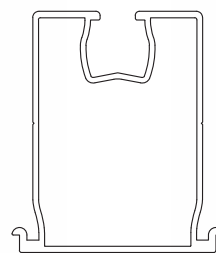

PURLIN

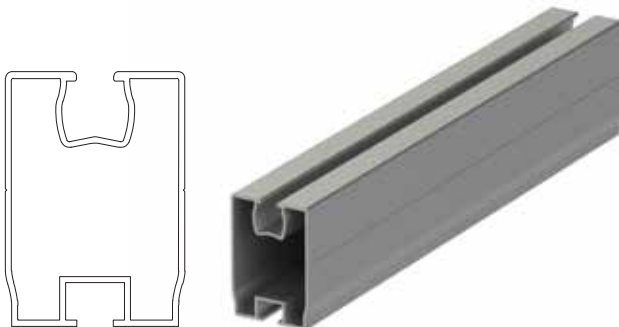

PURLIN

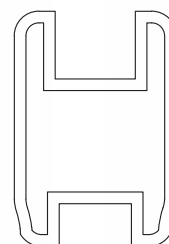

PURLIN JOINT



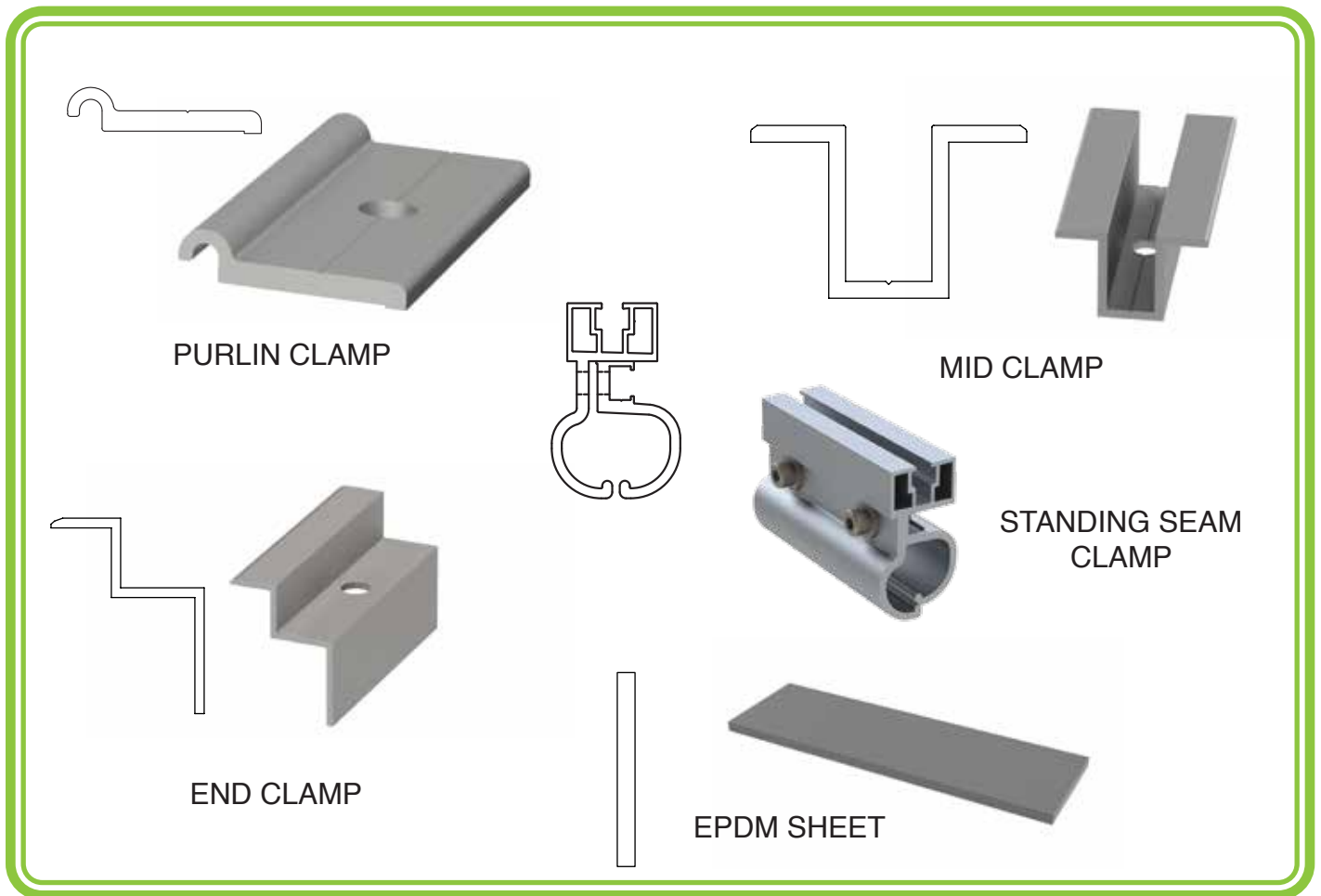

Engineered to Excellence

EDITION 2017



Quality Policy

"Excellence in Engineering"



“ We carry the Power”

Power Solution International

Solar Division

DUBAI

P.O Box: 113403, Dubai
Tel: + 971 - 4 - 3996671
Fax: + 971 - 4 - 3996672
sales@powersolutionme.com

FACTORY

UNITED ARAB EMIRATES

P.O Box: 16800, Ajman
Tel : +971 - 6 - 7480666
Fax: +971 - 6 - 7486435
sales@powersolutionme.com

KINGDOM OF SAUDI ARABIA

P.O Box: 245458, Riyadh
Tel : +966 -11- 2422511
Fax: +966 -11- 2445080
sales@powersolutionme.com

www.powersolutionme.com
www.powersolutionme-solar.com



Power Solution Industries LLC